



# Axle Components

<p>Tubular Axle Beams (Round &amp; Square) . . . . . B-2</p> <p>TORFLEX® Axle Beam . . . . . B-3</p> <p>Axle Spring Seats . . . . . B-3</p> <p>Brake Mounting Flanges . . . . . B-3</p> <p>Brake Mounting Bolts . . . . . B-3</p> <p>Brake Mounting Nuts &amp; Lockwashers . . . . . B-3</p> <p>Replacement Spindle Washers . . . . . B-4</p> <p>Replacement Spindle Nuts . . . . . B-4</p> <p>Packaged Spindle Nut Kits . . . . . B-4</p> <p>Spindles . . . . . B-5</p> <p><b>Agricultural Hubs:</b></p> <p>4 Bolt, 5" Bolt Circle . . . . . B-6</p> <p>5 Bolt, 5.5" Bolt Circle . . . . . B-6</p> <p>6 Bolt, 6" Bolt Circle . . . . . B-7 - B-8</p> <p>8 Bolt, 8" Bolt Circle . . . . . B-9</p> <p>Agricultural Spindles . . . . . B-9</p> <p>E-Z LUBE® End Units . . . . . B-10</p> <p><b>Replacement Idler Hub Assemblies:</b></p> <p>4 Bolt, 4" Bolt Circle . . . . . B-12</p> <p>5 Bolt, 4.5" Bolt Circle . . . . . B-13</p> <p>5 Bolt, 4.5", 4.75", 5" &amp; 5.5" Bolt Circle . . . . . B-14</p> <p>6 Bolt, 5.5" Bolt Circle . . . . . B-14 - B-16</p> <p>8 Bolt, 6.5" Bolt Circle . . . . . B-17</p> <p><b>Replacement Hub &amp; Drum Assemblies:</b></p> <p>4 Bolt, 4" Bolt Circle . . . . . B-18</p> <p>5 Bolt, 4.5" Bolt Circle . . . . . B-19</p> <p>5 Bolt, 4.5", 4.75", 5" &amp; 5.5" Bolt Circle . . . . . B-20</p> <p>6 Bolt, 5.5" Bolt Circle . . . . . B-21 - B-22</p> <p>5 Spoke, Utility Type (Grease &amp; Oil) . . . . . B-23</p> <p>8 Bolt, 6.5" Bolt Circle . . . . . B-23 - B-31</p> <p>8 Bolt, 275mm Bolt Circle (Dual Wheel) . . . . . B-32</p> <p>10 Bolt, 8.75" Bolt Circle (Dual Wheel) . . . . . B-32</p> <p><b>NEV-R-LUBE®:</b></p> <p>6 Bolt, 5.5" Bolt Circle . . . . . B-33 - B-34</p>	<p>8 Bolt 6.5" Bolt Circle . . . . . B-34</p> <p><b>Disc Brakes:</b></p> <p>5 Bolt, 4.5" Bolt Circle . . . . . B-35</p> <p>6 Bolt, 5.5" Bolt Circle . . . . . B-36</p> <p>8 Bolt, 6.5" Bolt Circle . . . . . B-37 - B-38</p> <p>Grease Seals, Oil Seals &amp; Wear Sleeves . . . . . B-39</p> <p>Grease Caps &amp; Cap Plugs . . . . . B-40</p> <p>Cap Driver Tools . . . . . B-40</p> <p>Oil Cap Replacement Parts . . . . . B-40</p> <p>Bolt-On Oil Caps . . . . . B-40</p> <p>Packaged Grease Caps . . . . . B-41</p> <p>Complete Oil Cap Kits . . . . . B-41</p> <p>Bearing Protectors . . . . . B-41</p> <p>Replacement Bearings . . . . . B-42</p> <p>Wheel Bearing Kits . . . . . B-43</p> <p>Replacement Races . . . . . B-43</p> <p>Wheel Studs - Drive In . . . . . B-44</p> <p>Wheel Studs - Screw In . . . . . B-44</p> <p>Wheel Bolts . . . . . B-44</p> <p>Packaged Wheel Bolts &amp; Studs . . . . . B-45</p> <p>Wheel Nuts . . . . . B-45</p> <p>Rim Clamps . . . . . B-45</p> <p>Packaged Rim Clamps &amp; Wheel Nuts . . . . . B-46</p> <p>Boxed Hub Assemblies . . . . . B-46</p> <p><b>Informational Pages:</b></p> <p>Equation to Figure Hub Face from Flange to Flange Dimension . . . . . B-2</p> <p>How To Order a Replacement Axle Beam . . . . . B-2</p> <p>Hub to Spindle Reference Chart . . . . . B-5</p> <p>How to Order Replacement Hubs or Hub &amp; Drums . . . . . B-11</p>
---	---

## How To Order a Replacement Axle Beam **DEXTER AXLE**

Answers to the following questions will provide us with all of the necessary information to get your axle beam ordered and in your hands quickly. Make sure you have the answers to these questions close at hand when placing your order.

AXLE COMPONENTS

- 1) Spindles: Are they straight, drop, E-Z LUBE® or Nev-R-Lube®?
- 2) Inner and Outer Bearings: What are the bearing numbers?
- 3) Seal: What is the I.D. and O.D. or Reference Number of the seal?
- 4) Tube: What is the outside diameter? Is the tube round or square?
- 5) Hub Face: What is the measurement from base of studs on one side to base of studs on other side?
- 6) Spring Pads: What is the measurement from center to center of pads?
- 7) Brake Flange: What is the measurement from outside to outside of brake flanges?



**New Marine Items!**

### Tubular Axle Beams\*

Straight Spindle			4" Drop Spindle	
STD. PART NO.	GALV/MARINE PART NO.	DESCRIPTION	STD. PART NO.	
T20BTR	N/A	2.2K, 1 3/4" ROUND	N/A	
T20BTR-EZ	T20BTR-EZG	2.2K, 1 3/4" ROUND W/ E-Z LUBE®	N/A	
N/A	M22BTR-EZG	2.2K, 2" SQUARE W/ E-Z LUBE®	N/A	
N/A	N/A	2.2K, 2 3/8" ROUND	TD20BTR	
N/A	N/A	2.2K, 2 3/8" ROUND W/ E-Z LUBE®	TD20BTR-EZ	
T3584F	N/A	3.5K, 2 3/8" ROUND	TD3584F	
T3584F-EZ	T3584F-EZG	3.5K, 2 3/8" ROUND W/ E-Z LUBE®	TD3584F-EZ	
N/A	M3584F-EZG	3.5K, 2" SQUARE W/ E-Z LUBE®	N/A	
T44DX	N/A	4.4K, 3" ROUND	N/A	
T44DX-EZ	N/A	4.4K, 3" ROUND W/ E-Z LUBE®	N/A	
T60R42F	N/A	6K, REGULAR DUTY, 3" ROUND	TD60R42F	
T60R42F-EZ	T60R42F-EZG	6K, REGULAR DUTY, 3" ROUND W/ E-Z LUBE®	TD60R42F-EZ	
T6042F	N/A	6K, 3" ROUND	TD6042F	
T6042F-EZ	T6042F-EZG	6K, 3" ROUND W/ E-Z LUBE®	TD6042F-EZ	
T70DX	N/A	7K, 3" ROUND	TD70DX	
T70DX-EZ	T70DX-EZG	7K, 3" ROUND W/ E-Z LUBE®	TD70DX-EZ	
T72DX	N/A	7.2K, 3" ROUND	TD72DX	
T72DX-EZ	N/A	7.2K, 3" ROUND W/ E-Z LUBE®	TD72DX-EZ	
T80DX	N/A	8K, 3 1/2" ROUND	TD80DX	
T80DX-EZ	N/A	8K, 3 1/2" ROUND W/ E-Z LUBE®	TD80DX-EZ	
T90DX7	N/A	*9K, 4" ROUND, 7 BOLT FLANGE	N/A	
T10GD-DX7	N/A	*10K, GENERAL DUTY, 5" ROUND, 7 BOLT FLANGE	N/A	
T10HD-DX7	N/A	10K, HEAVY DUTY, 5" ROUND, 7 BOLT FLANGE	N/A	
T10HD-AIR	N/A	10K, HEAVY DUTY, 5" ROUND, W/ AIR BRAKE SPIDER	N/A	

\*2K - 7K Axle Beams Available w/optional V-Bend and/or Stainless Spindle Wear Sleeves.

### Equation to Figure Hub Face from Flange to Flange Dimension

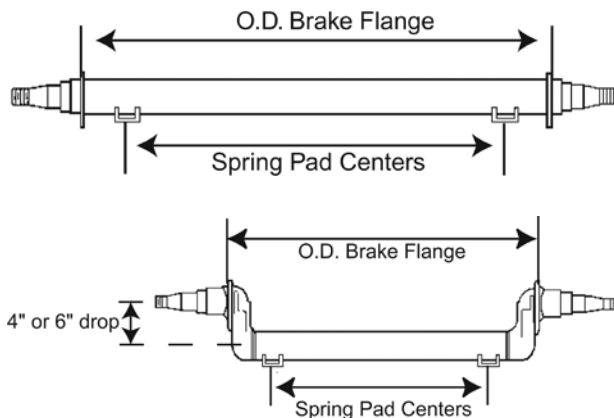

This chart is a handy guide for figuring the hub face dimensions, when you only have a bare beam with a flange from which to measure.

Axle Model - Equation
2K - Hub Face = Outside of flanges + 6.90
3.5K - Hub Face = Outside of flanges + 6.34
5.2K (655) - Hub Face = Outside of flanges + 8.73
6K, 7K (865) - Hub Face = Outside of flanges + 8.73
5.2K - 6K W/Demountable Hub - Track = Outside of flanges + 7.73
7.2K - Hub Face = Outside of flanges + 7.54
8K - Hub Face = Outside of flanges + 9.09
Old 9K - Hub Face = Outside of flanges + 10.46
9K, 10K GD (2-piece) - Hub Face = Outside of flanges + 13.50
9K-10K GD (1-Piece) - Hub Face = Outside of flanges + 10.98
10K Heavy Duty - Hub Face = Outside of flanges + 14.35
12K Low Profile - Hub Face = Outside of flanges + 21.77
12K High Profile - Hub Face = Outside of flanges + 15.27
15K - Hub Face = Outside of flanges + 17.45
10 on 11 1/4" Hub - Hub Face = Outside of flanges + 11.16
Tag Axle w/9-20 Drum - Hub Face = Outside of flanges + 17.19
Tag Axle w/9-23 Drum - Hub Face = Outside of flanges + 15.38

Note: These equations are valid for any axle where the same hub is used. For example, any hub that goes on a 3,500 lb. axle has a total flange to hub face difference of 6.34" regardless of whether it is a straight, drop or TORFLEX®.

\*9K & 10K GD axles built prior to July 27, 2009 must specify "OLD STYLE" Spindles.

## TORFLEX® Axle Beams\*



(Beam shown with V-Bend Option.)

STD SPINDLE PART NO.	DESCRIPTION	E-Z LUBE® SPINDLE	
		STD. PART NO.	GALV/MARINE REF. NO.
9TF20B	#9 TORFLEX® BEAM, 2.2K CAP, NO FLG	9TF20B-EZ	N/A
10TF35B	#10 TORFLEX® BEAM, 3.5K CAP, W/ FLG	10TF35B-EZ	10TF35B-EZG
11TF60B	#11 TORFLEX® BEAM, 6K CAP, W/ FLG	11TF60B-EZ	11TF60B-EZG
12TF70B	#12 TORFLEX® BEAM, 7K CAP, W/ FLG	12TF70B-EZ	12TF70B-EZG
12VTF72B	#12V TORFLEX® BEAM, 7.2K CAP, W/ FLG	12VTF72B-EZ	N/A
13TF80B	#13 TORFLEX® BEAM, 8K CAP, W/ FLG	13TF-80B-EZ	N/A

\*10TF-12TF Axle Beams Available w/optional V-Bend and/or stainless steel seal wear sleeves.



New Marine Items!

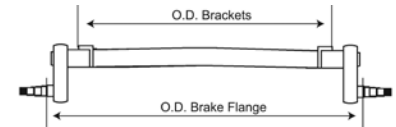

AXLE COMPONENTS

## Axle Spring Seats

PART NO.	REF. NO.	USE WITH:
3-49	172600	1 3/4" ROUND AXLE
3-43	172800	2 3/8" ROUND AXLE
3-42	173000	3" ROUND AXLE
3-48	173200	3 1/2" ROUND AXLE
3-51	173400	4" ROUND AXLE
3-72	173600	5" ROUND 10K AXLES W/ 2 1/2" WIDE SPRINGS
3-66	173800	5" ROUND AXLES W/ 3" WIDE SPRINGS



## Brake Mounting Flanges

PART NO.	REF. NO.	USE WITH:	BRAKE SIZE	HOLE I.D.
4-34	189200	1 3/4" ROUND AXLE	7", 4 BOLT	1.64"
4-35	189400	2 3/8" ROUND AXLE	10", 4 BOLT	2.27"
4-44-1	189600	3" ROUND AXLE	12", 5 BOLT	2.75"
721671	190000	2 1/4" ROUND, 2" SQUARE AXLES	12", 5 BOLT	2.30"
4-50	190200	3 1/2" ROUND AXLES	12 1/4", 8K, 4 BOLT	3.01"
4-48	190800	5" ROUND AXLES	10K, 12K, 15K, 7 BOLT	4.17"



## Brake Mounting Bolts

PART NO.	REF. NO.	USE WITH:	BRAKE SIZE	LENGTH
7-225	190950	12" X 2" BRAKES (#11 & #12 TORFLEX®)	3/8" - 16 SELF-TAPPING	3/4"
7-5	191000	12" X 2" BRAKES	3/8" - 24	1 1/4"
7-75	191700	10" BRAKES	7/16" - 20	1 1/4"
7-116	192200	10K, 12K, 15K BRAKES	7/16" - 20	1 3/4"
7-97	192800	8K, 9K BRAKES	1/2" - 20	1 1/2"



## Brake Mounting Nuts and Lockwashers

PART NO.	REF. NO.	DESCRIPTION	I.D.	USE WITH
38N	077600	NUT	3/8" - 24	12" BRAKES
38LW	191600	LOCKWASHER	3/8"	12" BRAKES
6-17	191800	NUT	7/16" - 20	10" BRAKES
5-8	192000	LOCKWASHER	7/16"	10" BRAKES
6-92	192600	LOCKNUT	7/16" - 20	10K, 12K, 15K BRAKES
6-46	193000	LOCKNUT	1/2" - 20	8K, 9K BRAKES



## Replacement Spindle Washers

AXLE  
COMPONENTS



Tongue Washer

Plain Washer



D Washer

Tang type "A"  
Washer



Tang type "B" Washer

PART NO.	REF. NO.	I.D.	TYPE
165863	166400	1"	TONGUE TYPE FOR REPLACEMENT SPINDLES
5-70	166600	1 1/2"	TONGUE TYPE FOR 9K & 10K GD
SW1000	167200	1"	PLAIN TYPE FOR REPLACEMENT SPINDLES
5-23	167400	1"	"D" TYPE FOR 3.5K & 6K REG DUTY
5-101	167600	1"	TANG TYPE "A" FOR E-Z LUBE® 2K TO 8K (OLD STYLE)
5-57	167800	1"	"D" TYPE FOR 6K, 7K, 8K, (& 9K PRIOR TO 10/89)
5-147-1	167825	1"	42MM NEV-R-LUBE®, .25 X 2.25
5-149	167830	1"	50MM NEV-R-LUBE®, .31 X 2.50
5-150	167835	1"	35MM NEV-R-LUBE®, .25 X 1.88
5-71	168400	1 1/2"	TANG TYPE "B" FOR 9K & 10K GD
5-59	168600	1 3/4"	TANG TYPE "B" FOR 10K, 12K & 15K
5-60	168800	1 3/4"	TONGUE TYPE FOR 10K, 12K & 15K

## Replacement Spindle Nuts



PART NO.	REF. NO.	DIAMETER	DESCRIPTION
165931	164600	7/8" - 14	CASTLE NUT, 6-CASTELLATION
165686	164800	1" - 14	CASTLE NUT, 6-CASTELLATION
6-176	164805	1" - 14	CASTLE NUT, 12-CASTELLATION (NEW STYLE)
6-183	164900	1" - 14	SELF-LOCKING, DEXTER NEV-R-LUBE®
6-190	164925	N/A	NUT RETAINER FOR 6-191
6-191	164950	1" - 14	JAM NUT 2K THRU 8K, NEW STYLE E-Z LUBE®
6-96	165200	1 1/2" - 12	NUT FOR 9K & 10K GD
6-84	165400	1 3/4" - 12	NUT FOR 10K, 12K & 15K
90623	165600	1 1/2" - 12	CASTLE NUT FOR #99 SPINDLE
6-114	165800	2 5/8" - 16	INNER NUT FOR 20K - 25K
6-115	166000	2 5/8" - 16	OUTER NUT FOR 20K - 25K

## Packaged Spindle Nut Kits



PART NO.	REF. NO.	DESCRIPTION
RG05-020	163100	1"-14 SPINDLE NUT, PKG 2EA, W/TONGUE WASHER & COTTER PIN
RG05-040	163110	1"-14 SPINDLE NUT, PKG 2EA, W/ D-WASHER & COTTER PIN
RG05-060	163120	1"-14 SPINDLE NUT, PKG 2EA, W/TANG & D-WASHER, E-Z LUBE® (OLD STYLE)
RG05-080	163130	1"-14 SPINDLE NUT, PKG 2EA W/PLAIN WSHR,COTTER PIN
RG05-100	163140	1"-14 SPINDLE NUT, PKG 2EA W/RETAINER, E-Z LUBE® (NEW STYLE)

## Spindles

Spindles come complete with spindle nut, washer and cotter key (tang washer supplied with grease lubed spindles). Note: Spindle dimensions shown are for identification purposes only and do not reflect min-max tolerances required for production of spindles.

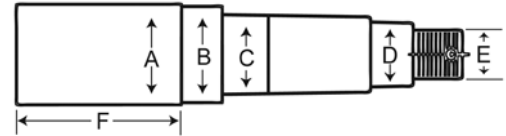
**AXLE COMPONENTS**

PART NO.	REF NO.	CAPACITY	A	B	C	D	E	F	DESCRIPTION
R104BT8	163200	1000 LB	1.25	1.24	.99	.99	1.00	4.00	BT8
R104BTREZ	163325	1000 LB	1.25	1.50	1.06	1.06	1.00	4.00	BTR GREASE LUBE (ZERK)
R104BT8-38	163400	1000 LB	1.38	1.24	.99	.99	1.00	4.00	BT8
R20484	163600	1750 LB	1.75	1.73	1.38	1.06	1.00	4.00	#84
R20384EZ	163725	1750 LB	1.75	1.73	1.38	1.06	1.00	3.00	#84 GREASE LUBE (ZERK) & FLG
R2061/284	163800	1750 LB	1.75	1.73	1.38	1.06	1.00	6.50	#84
R40484	163930	1750 LB	2.00	1.73	1.38	1.06	1.00	4.00	#84
R50642	164000	2500 LB	2.25	2.24	1.74	1.25	1.00	6.00	#42
R50342EZ	164125	2600 LB	2.25	2.24	1.74	1.25	1.00	3.00	#42 GREASE LUBE (ZERK) & FLG
SP204BT8	164200	1000 LB	1.50	1.24	.99	.99	1.00	4.00	BT8, 1.5" SQUARE
SP20484	164400	1750 LB	1.50	1.73	1.38	1.06	1.00	4.00	#84, 1.5" SQUARE
SP50642	164510	2600 LB	2.00	2.24	1.74	1.25	1.00	6.00	#42, 2.0" SQUARE

## Hub to Spindle Reference Chart

Use the following chart when matching hubs to spindles. Choose capacity, bolt pattern and desired shank size. The chart lists spindle part number first, hub part number second.

1,000 lb. Capacity					
		1 1/4" ROUND, 4" LONG	1 3/8" ROUND, 4" LONG	1 1/2" SQUARE, 4" LONG	1 1/4" ROUND 4" LONG, LUBE
		BOLT PATTERN			
SPINDLE PART NO.	4 ON 4"	R104BT8	R104BT8-38	SP204BT8	R104BTREZ
HUB PART NO.		34822UC1	34822UC1	34822UC1	8-91-05UC1-EZ
SPINDLE PART NO.	5 ON 4 1/2"	R104BT8	R104BT8-38	SP204BT8	R104BTREZ
HUB PART NO.		34822545UC1	34822545UC1	34822545UC1	8-259-5UC1-EZ

1,750 lb. Capacity					
		1 3/4" ROUND, 4" LONG	1 3/4" ROUND, 6 1/2" LONG	1 1/2" SQUARE, 4" LONG	1 3/4" ROUND 3" LONG, LUBE
		BOLT PATTERN			
SPINDLE PART NO.	5 ON 4 1/2"	R20484	R2061/284	SP20484	R20384EZ
HUB PART NO.		84545UC1	84545UC1	84545UC1	84545UC1-EZ
SPINDLE PART NO.	5 ON 4 3/4"	R20484	R2061/284	SP20484	R20384EZ
HUB PART NO.		845475UC1	845475UC1	845475UC1	845475UC1-EZ
SPINDLE PART NO.	5 ON 5"	R20484	R2061/284	SP20484	R20384EZ
HUB PART NO.		84550UC1	84550UC1	84550UC1	84550UC1-EZ
SPINDLE PART NO.	5 ON 5 1/2"	R20484	R2061/284	SP20484	R20384EZ
HUB PART NO.		84555UC1	84555UC1	84555UC1	84555UC1-EZ
SPINDLE PART NO.	6 ON 5 1/2"	R20484	R2061/284	SP20484	R20384EZ
HUB PART NO.		84655UC1	84655UC1	84655UC1	84655UC1-EZ

		2,500 lb. Capacity		2,600 lb. Capacity	
		2 1/4" ROUND X 6" LONG		2 1/4" ROUND X 3" LONG, LUBE	
		BOLT PATTERN			
SPINDLE PART NO.	6 ON 5 1/2"	R50642	R50342EZ		
HUB PART NO.		42655UC1	8-213-5UC1-EZ		
SPINDLE PART NO.	8 ON 6 1/2"	R50642	R50342EZ		
HUB PART NO.		42865UC1	8-231-9UC1-EZ		

## Agricultural Hubs

We have Agricultural Hubs and Spindles in the most popular bolt patterns for use in building or repairing implement wagons, carts or machinery. Agricultural hubs and spindles are designed for low-speed applications; weight capacities shown for speeds not to exceed 20 m.p.h.

### 4 Bolt, 5" Bolt Circle

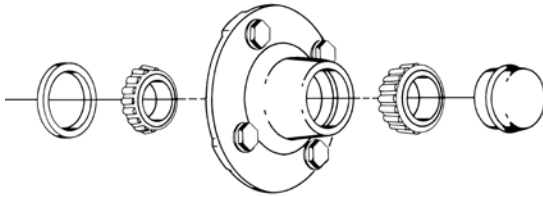

- **LM67048 Inner, LM11949 Outer Bearing**
- Capacity of 1,500 lbs. per each
- Use with spindle #AS1500E

PART NO.	REF. NO.	DESCRIPTION
AH15450ECOMP	125600	COMPLETE HUB ASSY- INCLUDES THE FOLLOWING
AH15450E	125400	AGRICULTURAL HUB ONLY, DRILLED & TAPPED
LM67048	130000	INNER BEARING
LM11949	133200	OUTER BEARING
LM67010	135400	INNER RACE
LM11910	139000	OUTER RACE
SL150	160400	GREASE SEAL (2.332" O.D., 1.50" I.D.), SINGLE LIP
1527	151000	GREASE CAP, 1.957" O.D., DRIVE-IN
LB509	143300	WHEEL BOLT, 1/2" DIAMETER

### 5 Bolt, 5.5" Bolt Circle

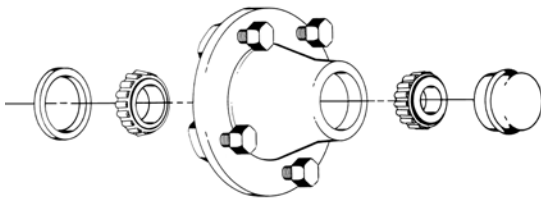

- **LM48548 Inner, LM67048 Outer Bearing**
- Capacity of 2,500 lbs. per each
- Use with spindle #AS2500F

PART NO.	REF. NO.	DESCRIPTION
AH25555FCOMP	126000	COMPLETE HUB ASSY- INCLUDES THE FOLLOWING
AH25555F	125800	AGRICULTURAL HUB ONLY, DRILLED & TAPPED
LM48548	129800	INNER BEARING
LM67048	130000	OUTER BEARING
LM48510	135200	INNER RACE
LM67010	135400	OUTER RACE
SL175	160600	GREASE SEAL (2.722" O.D., 1.75" I.D.), SINGLE LIP
45896	151600	GREASE CAP, 2.44" O.D., DRIVE-IN
LB509	143300	WHEEL BOLT, 1/2" DIAMETER

Agricultural Spindles Shown on Page B-9

## 6 Bolt, 6" Bolt Circle

- **LM29749 Inner, LM67048 Outer Bearing**
- Capacity of 3,000 lbs. per each
- Use with spindle #AS3000F

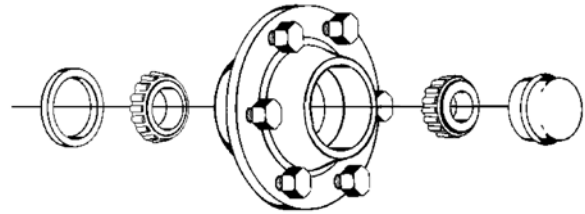

AXLE  
COMPONENTS

PART NO.	REF. NO.	DESCRIPTION
AH30660FCOMP	126400	COMPLETE HUB ASSY- INCLUDES THE FOLLOWING
AH30660F	126200	AGRICULTURAL HUB ONLY, DRILLED & TAPPED
LM29749	133600	INNER BEARING
LM67048	130000	OUTER BEARING
LM29710	139200	INNER RACE
LM67010	135400	OUTER RACE
SL175	160600	GREASE SEAL (2.722" O.D., 1.75" I.D.), SINGLE LIP
45896	151600	GREASE CAP, 2.44" O.D., DRIVE-IN
LB509	143300	WHEEL BOLT, 1/2" DIAMETER

## 6 Bolt, 6" Bolt Circle

- **LM501349 Inner, LM67048 Outer Bearing**
- Capacity of 3,500 lbs. per each
- Use with spindle #AS3500F

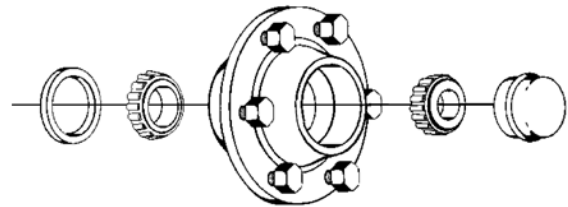

PART NO.	REF. NO.	DESCRIPTION
AH35660F-SCOMP	126825	COMPLETE HUB ASSY- INCLUDES THE FOLLOWING
AH35660F-S	126625	AGRICULTURAL HUB ONLY, STUDDED
LM501349	133800	INNER BEARING
LM501310	130000	OUTER BEARING
501310	139400	INNER RACE
LM67010	135400	OUTER RACE
SL200	160800	GREASE SEAL (3.066" O.D., 2.00" I.D.), SINGLE LIP
45896	151600	GREASE CAP, 2.44" O.D., DRIVE-IN
STN569	140200	9/16" HEX WHEEL NUT

## 6 Bolt, 6" Bolt Circle

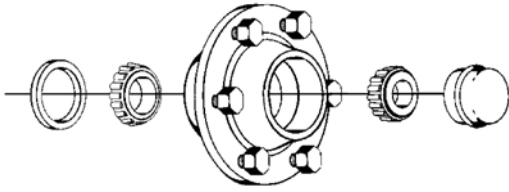

- **25580 Inner, LM67048 Outer Bearing**
- Capacity of 3,000 lbs. per each
- Use with #42 spindles
- For spindles requiring 2 1/4" I.D. grease seal



PART NO.	REF. NO.	DESCRIPTION
42660UC1	126150	COMPLETE HUB ASSY- INCLUDES THE FOLLOWING
8-213-8	126100	AGRICULTURAL HUB ONLY, DRILLED & TAPPED
25580	130800	INNER BEARING
LM67048	130000	OUTER BEARING
25520	136200	INNER RACE
LM67010	135400	OUTER RACE
42385	159600	GREASE SEAL (3.376" O.D., 2.250" I.D.), SINGLE LIP
45896	151600	GREASE CAP, 2.44" O.D., DRIVE-IN
LB569	143400	WHEEL BOLT, 9/16" DIAMETER

## 6 Bolt, 6" Bolt Circle

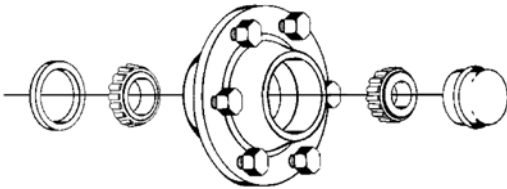

- **25580 Inner, LM67048 Outer Bearing**
- Capacity of 3,000 lbs. per each
- Fits Dexter 5,200 lbs. thru 7,000 lb. axles
- For Spindles requiring 2 1/8" I.D. Grease Seal



PART NO.	REF. NO.	DESCRIPTION
8-213-8UC1	126125	COMPLETE HUB ASSY- INCLUDES THE FOLLOWING
8-213-8	126100	AGRICULTURAL HUB ONLY, DRILLED & TAPPED
25580	130800	INNER BEARING
LM67048	130000	OUTER BEARING
25520	136200	INNER RACE
LM67010	135400	OUTER RACE
10-1	159800	GREASE SEAL (3.376" O.D., 2.125" I.D.), SINGLE LIP
45896	151600	GREASE CAP, 2.44" O.D., DRIVE-IN
LB569	143400	WHEEL BOLT, 9/16" DIAMETER

## 8 Bolt, 8" Bolt Circle

- **603049 Inner, LM67048 Outer Bearing**
- Capacity of 4,500 lbs. per each
- Use with spindle #AS4500F

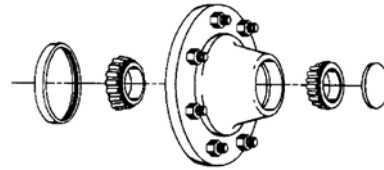

PART NO.	REF. NO.	DESCRIPTION
AH45880F-SCOMP	127250	COMPLETE HUB ASSY- INCLUDES THE FOLLOWING
AH45880F-S	127225	AGRICULTURAL HUB ONLY
LM603049	134200	INNER BEARING
LM67048	130000	OUTER BEARING
LM67010	135400	OUTER RACE
SL226	161000	GREASE SEAL (3.066" O.D., 2.250" I.D.), SINGLE LIP
45896	151600	GREASE CAP, 2.44" O.D., DRIVE-IN
STN569	140200	9/16" HEX WHEEL NUT

## 8 Bolt, 8" Bolt Circle

- **501349 Outer, 506849 Inner Bearing**
- Capacity of 6,000 lbs. per each
- Use with spindle #AS6000F

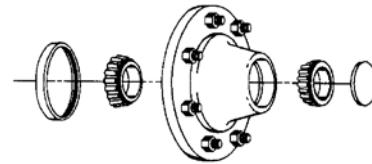

PART NO.	REF. NO.	DESCRIPTION
AH60880FCOMP	127400	COMPLETE HUB ASSY- INCLUDES THE FOLLOWING
AH60880F	127300	AGRICULTURAL HUB ONLY
LM506849	134000	INNER BEARING
LM501349	133800	OUTER BEARING
LM501310	139400	OUTER RACE
SL275	161200	GREASE SEAL (3.756" O.D., 2.75" I.D.), SINGLE LIP
1609	152600	GREASE CAP, 3.125" O.D., DRIVE-IN
6-109	141000	5/8" HEX WHEEL NUT RH

## Agricultural Spindles

Each spindle comes complete with nuts and washers.

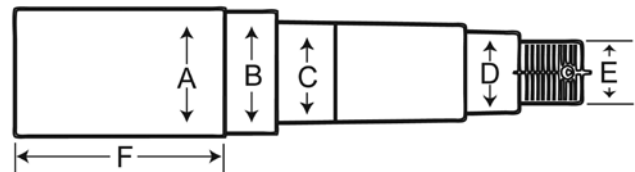

PART NO.	REF NO.	CAPACITY	A	B	C	D	E	F
AS1500E	127600	1500 LB	1.62	1.50	1.25	.75	3/4"-16 UNF	5 3/8
AS2500F	127800	2500 LB	1.75	1.75	1.37	1.25	3/4"-16 UNF	8
AS3000F	128000	3000 LB	1.75	1.75	1.50	1.25	3/4"-16 UNF	5
AS3500F	128200	3500 LB	2.00	2.00	1.63	1.25	3/4"-16 UNF	5 1/2
AS4500F	128400	4500 LB	2.25	2.25	1.78	1.25	3/4"-16 UNF	8 1/4
AS6000F	128600	6000 LB	2.75	2.75	2.16	1.63	1"-14 UNF	8 1/4



**DEXTER AXLE**

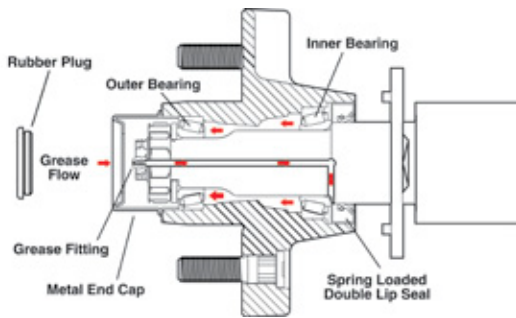
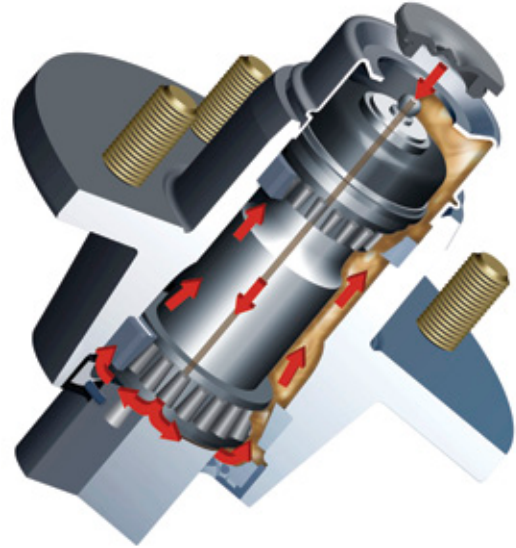

For custom building axles, or anywhere a spindle/hub would be preferred over a complete axle. Examples include: portable welders, cattle “squeeze-chutes”, industrial dollies, etc. These End Units come completely assembled and feature the E-Z LUBE® option for easier bearing lubrication. Available with idler hubs and with electric or hydraulic brakes.

PART NO.	REF. NO.	CAPACITY PER PAIR	BOLT PATTERN	HUB TYPE	SHANK SIZE
20440IEU	105050	2200	4 ON 4"	IDLER	1 1/4" X 4"
20545IEU	105055	2200	5 ON 4 1/2"	IDLER (6.5" HUB FLG)	1 1/4" X 4"
35545IEU	105060	3500	5 ON 4 1/2"	IDLER	1 3/4" X 3"
35545EEULH	105065	3500	5 ON 4 1/2"	LH ELECTRIC	1 3/4" X 3"
35545EEURH	105070	3500	5 ON 4 1/2"	RH ELECTRIC	1 3/4" X 3"
35545HEULH	105075	3500	5 ON 4 1/2"	LH UNI-SERVO	1 3/4" X 3"
35545HEURH	105080	3500	5 ON 4 1/2"	RH UNI-SERVO	1 3/4" X 3"
52655IEU	105085	5200	6 ON 5 1/2"	IDLER	2 1/4" X 3"
52655EEULH	105095	5200	6 ON 5 1/2"	LH ELECTRIC	2 1/4" X 3"
52655EEURH	105100	5200	6 ON 5 1/2"	RH ELECTRIC	2 1/4" X 3"
52655HEULH	105102	5200	6 ON 5 1/2"	LH UNI-SERVO	2 1/4" X 3"
52655HEURH	105104	5200	6 ON 5 1/2"	RH UNI-SERVO	2 1/4" X 3"
52655HYEULH	105106	5200	6 ON 5 1/2"	LH DUO-SERVO	2 1/4" X 3"
52655HYEURH	105108	5200	6 ON 5 1/2"	RH DUO-SERVO	2 1/4" X 3"
52865IEU	105110	5200	8 ON 6 1/2"	IDLER	2 1/4" X 3"
52865EEULH	105112	5200	8 ON 6 1/2"	LH ELECTRIC	2 1/4" X 3"
52865EEURH	105114	5200	8 ON 6 1/2"	RH ELECTRIC	2 1/4" X 3"
52865HEULH	105125	5200	8 ON 6 1/2"	LH UNI-SERVO	2 1/4" X 3"
52865HEURH	105130	5200	8 ON 6 1/2"	RH UNI-SERVO	2 1/4" X 3"
52865HYEULH	105145	5200	8 ON 6 1/2"	LH DUO-SERVO	2 1/4" X 3"
52865HYEURH	105150	5200	8 ON 6 1/2"	RH DUO-SERVO	2 1/4" X 3"

## How to Order Replacement Hubs or Hub & Drum

To order the correct replacement hub or hub and drum, the following steps can be used to simplify the ordering process:

1. **Determine the Bolt Pattern of the Hub.**  
Refer to page E-6 of this catalog for instructions on making this determination.
2. **Determine the Inner and Outer Bearing Numbers. Note whether the bearings use grease or oil bath lubrication.**
3. **Measure the old hub seal to insure that the I.D. and O.D. dimensions will be the same.**
4. **Verify the Stud Diameter.**
5. **If the axle is a brake axle, measure the diameter and width of the brake to determine brake size.**
6. **Look for any casting numbers on front or rear of hub or hub and drum.**
7. **On heavier axles, such as the Dexter 8,000 lb. or 9,000 lb. axles, you need to determine the hub pilot diameter. This can be accomplished by measuring the center hole of your wheel.**
8. **On 8,000 lb and larger axles determine if it is equipped with ABS, and requires a drum / rotor with ABS exciter ring installed.**

Once you have the above information, you are ready to locate your replacement hub or hub and drum. Hubs are listed on pages B-12 thru B-17. Hub and drums are listed on pages B-18 thru B-34. Locate the bolt pattern desired, then find the table that lists our inner and outer bearing numbers.

Verify: Inner/Outer Bearing Numbers  
Type of Bearing Lubrication  
Stud Size  
Seal Size  
Drum Size

Confirm brake size and/or hub pilot diameter (if applicable). Complete assemblies contain the hub or hub and drum, inner and outer bearings, seal, grease cap or oil cap and all necessary wheel nuts.



Hubs are Shown on Pages B-12 thru B-17  
Hub and Drums are Shown on Pages B-18 thru B-34

Replacement Hubs are listed in order of bolt pattern, starting with 4-bolt, and ending with 8-bolt.  
All are cast iron, one-piece units for durability.

### 4 Bolt, 4" Bolt Circle

AXLE  
COMPONENTS

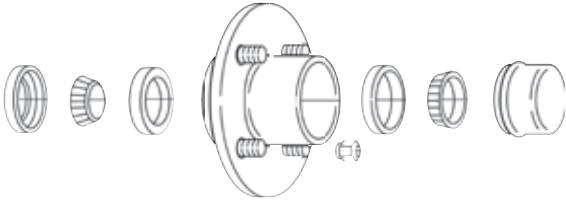

- Fits BT8 1" Spindle, L44643 inner/outer bearings
- Capacity of 1,000 lbs. per each



PART NO.	REF. NO.	DESCRIPTION
34822UC1	105400	COMPLETE HUB ASSEMBLY
34822	105200	HUB ONLY
L44643	128800	INNER / OUTER BEARING
L44610	134400	INNER / OUTER RACE
34823	157800	GREASE SEAL (1.983" O.D., 1.249" I.D.), SINGLE LIP
12192TB	157805	GREASE SEAL (1.983" O.D., 1.249" I.D.), DBL LIP "OPTIONAL"
46749	151200	GREASE CAP, 1.986" O.D., DRIVE-IN
25-53	147800	SCREW IN STUD, 1/2" DIAMETER (OLD STYLE)
09251510	144750	DRIVE-IN STUD, 1/2" DIAMETER (NEW STYLE)
X1023R	140600	1/2" CONE WHEEL NUT

### 4 Bolt, 4" Bolt Circle

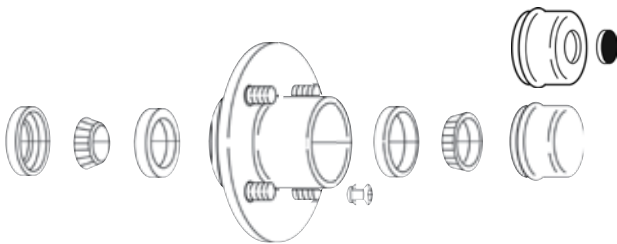

- BTR 1 1/16" spindle, L44649 inner / outer bearings
- Fits Dexter 2,200 lb. axle
- Std. Grease or E-Z LUBE® Application



PART NO.	REF. NO.	DESCRIPTION
8-91-05UC1	105800	COMPLETE HUB ASSEMBLY
8-91-05UC1-EZ	105825	COMPLETE E-Z LUBE® HUB ASSEMBLY
34822	105200	HUB ONLY
L44649	129000	INNER / OUTER BEARING
L44610	134400	INNER / OUTER RACE
10-9	158000	GREASE SEAL (1.987" O.D., 1.5" I.D.), SINGLE LIP
10-60	158200	GREASE SEAL (1.987" O.D., 1.5" I.D.), FOR E-Z LUBE®, DBL LIP
46749	151200	GREASE CAP, 1.986" O.D., DRIVE-IN
21-41-1	151400	GREASE CAP, 1.986" O.D., DRIVE-IN FOR E-Z LUBE®
85-1	155400	GREASE CAP PLUG FOR E-Z LUBE®
25-53	147800	SCREW-IN STUD, 1/2" DIAMETER (OLD STYLE)
09251510	144750	DRIVE-IN STUD, 1/2" DIAMETER (NEW STYLE)
X1023R	140600	1/2" CONE WHEEL NUT

## 5 Bolt, 4.5" Bolt Circle

- Fits BT8 1" Spindle, L44643 inner/outer bearings
- Capacity of 1,000 lbs. per each
- 5 1/2" diameter hub flange, use with 8" to 12" wheels
- 6 1/2" diameter hub flange, use with 13" to 15" wheels
- Std. Paint or "GAL-DEX™"\* corrosion resistant finish (Marine)

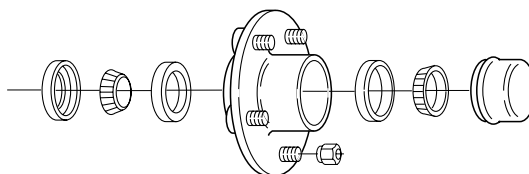

PART NO.	REF. NO.	DESCRIPTION
34822545UC1	106200	COMPLETE HUB ASSEMBLY, 5 1/2" HUB FLANGE, PAINTED
8-259-50BTUC1	106220	COMPLETE HUB ASSEMBLY, 5 1/2" HUB FLANGE, GAL-DEX™
34822545	106000	HUB ONLY, 5 1/2" HUB FLANGE, PAINTED
8-259-50	106215	HUB ONLY, 5 1/2" HUB FLANGE, GAL-DEX™
8-258BTUC1	106310	COMPLETE HUB ASSEMBLY, 6 1/2" HUB FLANGE, PAINTED
8-258-50BTUC1	106635	COMPLETE HUB ASSEMBLY, 6 1/2" HUB FLANGE, GAL-DEX™
8-258-5	106300	HUB ONLY, 6 1/2" HUB FLANGE, PAINTED
8-258-50	106630	HUB ONLY, 6 1/2" HUB FLANGE, GAL-DEX™
L44643	128800	INNER / OUTER BEARING
L44610	134400	INNER / OUTER RACE
34823	157800	GREASE SEAL (1.983" O.D., 1.249" I.D.), SINGLE LIP
12192TB	157805	GREASE SEAL (1.983" O.D., 1.249" I.D.), DBL LIP, "OPTIONAL"
46749	151200	GREASE CAP, 1.986" O.D., DRIVE-IN
25-53	147800	SCREW-IN STUD, 1/2" DIAMETER (OLD STYLE)
0925150	144750	DRIVE-IN STUD, 1/2" DIAMETER (NEW STYLE)
7-246-1	144735	DRIVE-IN STUD, 1/2" DIAMETER, ZINC
X1023R	140600	1/2" CONE WHEEL NUT

\*GAL-DEX™ Marine Hubs have Zinc Rich Galvanic Coating with Zinc Studs.

New Marine Items!



AXLE COMPONENTS

## 5 Bolt, 4.5" Bolt Circle

- BTR 1 1/16" spindle, L44649 inner / outer bearings
- Fits Dexter 2,200 lb. axle
- Std. Grease or E-Z LUBE® Application
- 5 1/2" diameter hub flange, use with 8" to 12" wheels
- 6 1/2" diameter hub flange, use with 13" to 15" wheels
- Std. Paint or "GAL-DEX™"\* corrosion resistant finish (Marine)

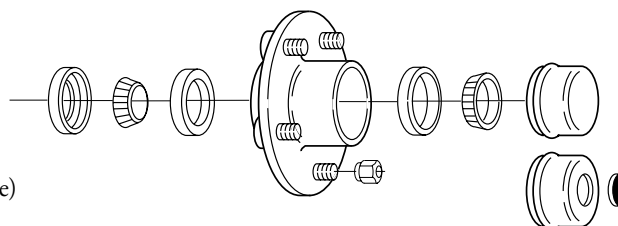

PART NO.	REF. NO.	DESCRIPTION
8-259-5UC1	106600	COMPLETE HUB ASSEMBLY, 5 1/2" HUB FLANGE, PAINTED
8-259-50UC1	106225	COMPLETE HUB ASSEMBLY, 5 1/2" HUB FLANGE, GAL-DEX™
8-259-5UC1-EZ	106625	COMPLETE E-Z LUBE® HUB ASSY, 5 1/2" HUB FLG, PAINTED
8-259-50UC1-EZ	106235	COMPLETE E-Z LUBE® HUB ASSY, 5 1/2" HUB FLG, GAL-DEX™
34822545	106000	HUB ONLY, 5 1/2" HUB FLANGE, PAINTED
8-259-50	106215	HUB ONLY, 5 1/2" HUB FLANGE, GAL-DEX™
8-258-5UC1	106325	COMPLETE HUB ASSEMBLY, 6 1/2" HUB FLG, PAINTED
8-258-50UC1	106640	COMPLETE HUB ASSEMBLY, 6 1/2" HUB FLG, GAL-DEX™
8-258-5UC1-EZ	106330	COMPLETE E-Z LUBE® HUB ASSY, 6 1/2" HUB FLG, PAINTED
8-258-50UC1-EZ	106650	COMPLETE E-Z LUBE® HUB ASSY, 6 1/2" HUB FLG, GAL-DEX™
8-258-5	106300	HUB ONLY, 6 1/2" HUB FLANGE, PAINTED
8-258-50	106630	HUB ONLY, 6 1/2" HUB FLANGE, GAL-DEX™
L44649	129000	INNER / OUTER BEARING
L44610	134400	INNER / OUTER RACE
10-9	158000	GRS SEAL (1.987" O.D., 1.5" I.D.), SINGLE LIP
10-60	158200	GRS SEAL (1.987" O.D., 1.5" I.D.), FOR E-Z LUBE®, DBL LIP
46749	151200	GREASE CAP, 1.986" O.D., DRIVE-IN
21-41-1	151400	GREASE CAP, 1.986" O.D., DRIVE-IN, FOR E-Z LUBE®
85-1	155400	GREASE CAP PLUG FOR E-Z LUBE®
25-53	147800	SCREW-IN STUD, 1/2" DIAMETER (OLD STYLE)
09251510	144750	DRIVE-IN STUD, 1/2" DIAMETER (NEW STYLE)
7-246-1	144755	DRIVE-IN STUD, 1/2" DIAMETER, ZINC
X1023R	140600	1/2" CONE WHEEL NUT

\*GAL-DEX™ Marine Hubs have Zinc Rich Galvanic Coating with Zinc Studs.

New Marine Items!



## 5 Bolt, 4.5", 4.75", 5" & 5.5" Bolt Circle

AXLE COMPONENTS

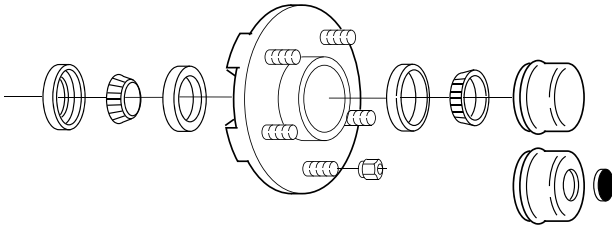

- **L68149 Inner / L44649 Outer Bearings**
- Capacity of 1,750 lbs. per each
- Fits #84 Spindle
- Std. Grease or E-Z LUBE® Application
- Used on Dexter and most 3,500 lb. axles
- 4 different bolt patterns
- For Idler applications only. See page B-35 for Disc Brake Hubs & Components
- 5 on 4.5" Hub Available in Painted or "GAL-DEX™" corrosion resistant finish (Marine)

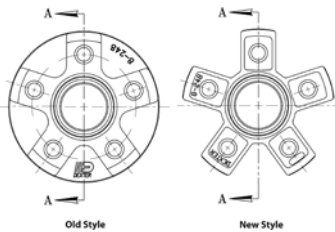

**New Marine Items!**



PART NO.	REF. NO.	DESCRIPTION
84545UC1	107000	COMPLETE HUB ASSEMBLY, 4 1/2" BOLT CIRCLE, PAINTED
8-248-50UC1	107035	COMPLETE HUB ASSEMBLY, 4 1/2" BOLT CIRCLE, GAL-DEX™
84545UC1-EZ	107025	COMPLETE E-Z LUBE® HUB ASSY, 4 1/2" BOLT CIRCLE, PAINTED
8-248-50UC1-EZ	107040	COMPLETE E-Z LUBE® HUB ASSY, 4 1/2" BOLT CIRCLE, GAL-DEX™
84545	106800	HUB ONLY, 4 1/2" BOLT CIRCLE, PAINTED
8-248-50	107030	HUB ONLY, 4 1/2" BOLT CIRCLE, GAL-DEX™
845475UC1	107400	COMPLETE HUB ASSEMBLY, 4 3/4" BOLT CIRCLE
845475UC1-EZ	107425	COMPLETE E-Z LUBE® HUB ASSEMBLY, 4 3/4" BOLT CIRCLE
845475	107200	HUB ONLY, 4 3/4" BOLT CIRCLE
84550UC1	107800	COMPLETE HUB ASSEMBLY, 5" BOLT CIRCLE
84550UC1-EZ	107825	COMPLETE E-Z LUBE® HUB ASSEMBLY, 5" BOLT CIRCLE
84550	107600	HUB ONLY, 5" BOLT CIRCLE
84555UC1	108200	COMPLETE HUB ASSEMBLY, 5 1/2" BOLT CIRCLE
84555UC1-EZ	108225	COMPLETE E-Z LUBE® HUB ASSEMBLY, 5 1/2" BOLT CIRCLE
84555	108000	HUB ONLY, 5 1/2" BOLT CIRCLE
L68149	129200	INNER BEARING
L44649	129000	OUTER BEARING
L68111	135000	INNER RACE
L44610	134400	OUTER RACE
58846	158800	GREASE SEAL (2.565" O.D., 1.719" I.D.), SINGLE LIP
10-19	159000	GREASE SEAL (2.565" O.D., 1.719" I.D.), FOR E-Z LUBE®, DBL LIP
46749	151200	GREASE CAP, 1.986" O.D., DRIVE-IN
21-3-1	151400	GREASE CAP, 1.986" O.D., DRIVE-IN, FOR E-Z LUBE®
85-1	155400	GREASE CAP PLUG FOR E-Z LUBE®
7-122	144600	DRIVE-IN STUD, 1/2" DIAMETER, 2" LONG
7-150	144800	DRIVE-IN STUD, 1/2" DIAMETER, 2 1/4" LONG, ZINC
X1023R	140600	1/2" CONE WHEEL NUT

\*GAL-DEX™ Marine Hubs have Zinc Rich Galvanic Coating with Zinc Studs.

## 6 Bolt, 5.5" Bolt Circle

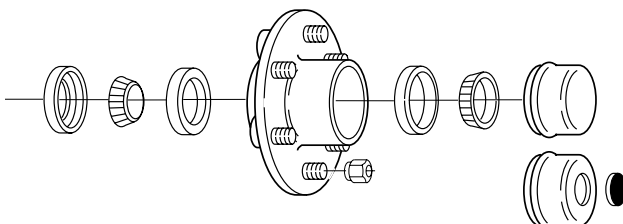

- **L68149 Inner / L44649 Outer Bearing**
- Capacity of 1,750 lbs. per each
- Fits #84 Spindle
- Std. Grease or E-Z LUBE® Application
- Used on Dexter and most 3,500 lb. axles

PART NO.	REF. NO.	DESCRIPTION
84655UC1	108600	COMPLETE HUB ASSEMBLY
84655UC1-EZ	108625	COMPLETE E-Z LUBE® HUB ASSEMBLY
84655	108400	HUB ONLY

Components of this hub are the same as listed in the table above.

## 6 Bolt, 5.5" Bolt Circle

- **25580 Inner / 15123 Outer Bearings**
- Capacity of 3,000 lbs. per each
- Fits 6,000 lb. axles
- For Spindles requiring 2 1/8", or 2 1/4" I.D. Grease Seal
- Std. Grease or E-Z LUBE® Application
- For Idler applications only. See page B-36 for Disc Brake Hubs & Components
- Std. Paint or "GAL-DEX™"\* corrosion resistant finish (Marine)

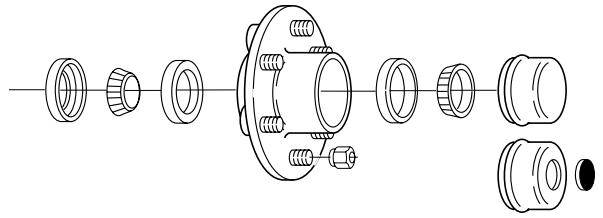

AXLE COMPONENTS

PART NO.	REF. NO.	DESCRIPTION
42655UC1	109800	COMPLETE HUB ASSEMBLY, 2 1/4" I.D. SEAL, PAINTED
8-213-51UC1	109818	COMPLETE HUB ASSEMBLY, 2 1/4" I.D. SEAL, GAL-DEX™
42655UC1-EZ	109810	COMPLETE E-Z LUBE® HUB ASSY, 2 1/4" I.D. SEAL, PAINTED
8-213-51UC1-EZ	109820	COMPLETE E-Z LUBE® HUB ASSY, 2 1/4" I.D. SEAL, GAL-DEX™
8-213-9UC1	109900	COMPLETE HUB ASSEMBLY, 2 1/8" I.D. SEAL, PAINTED
8-213-9UC1-EZ	109950	COMPLETE E-Z LUBE® HUB ASSY, 2 1/8" I.D. SEAL, PAINTED
42655	109600	HUB ONLY, PAINTED
8-213-51	109815	HUB ONLY, GAL-DEX™
25580	130800	INNER BEARING
15123	130400	OUTER BEARING
25520	136200	INNER RACE
15245	135600	OUTER RACE
42385	159600	GREASE SEAL (3.376" O.D., 2.25" I.D.), SINGLE LIP
10-36	159200	GREASE SEAL (3.376" O.D., 2.25" I.D.), DBL LIP
10-1	159800	GREASE SEAL (3.376" O.D., 2.125" I.D.), SINGLE LIP
10-10	160000	GREASE SEAL (3.376" O.D., 2.125" I.D.), FOR E-Z LUBE®, DBL LIP
45896	151600	GREASE CAP, 2.44" O.D., DRIVE-IN
21-42-1	151800	GREASE CAP, 2.44" O.D., DRIVE-IN, FOR E-Z LUBE®
85-1	155400	GREASE CAP PLUG FOR E-Z LUBE®
7-122	144600	DRIVE-IN STUD, 1/2" DIAMETER, 2" LONG
7-150	144800	DRIVE-IN STUD, 1/2" DIAMETER, 2 1/4" LONG, ZINC
X1023R	140600	1/2" CONE WHEEL NUT

\*GAL-DEX™ Marine Hubs have Zinc Rich Galvanic Coating with Zinc Studs.



**New Marine Items!**



## 6 Bolt, 5.5" Bolt Circle

- **25580 Inner / LM67048 Outer Bearings**
- Capacity of 3,000 lbs. per each
- Fits Dexter 5,200 lb. and 6,000 lb. axles
- Std. Grease or E-Z LUBE® Application
- For Spindles requiring 2 1/8" I.D. Grease Seal
- For Idler applications only. See page B-36 for Disc Brake Hubs & Components
- Std. Paint or "GAL-DEX™"\* corrosion resistant finish (Marine)

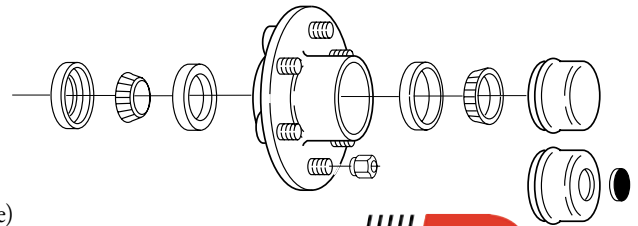

PART NO.	REF. NO.	DESCRIPTION
8-213-5UC1	110200	COMPLETE HUB ASSEMBLY, PAINTED
8-213-50UC1	110230	COMPLETE HUB ASSEMBLY, GAL-DEX™
8-213-5UC1-EZ	110225	COMPLETE E-Z LUBE® HUB ASSEMBLY, PAINTED
8-213-50UC1-EZ	110240	COMPLETE E-Z LUBE® HUB ASSEMBLY, GAL-DEX™
8-213-5	110000	HUB ONLY, PAINTED
8-213-50	110230	HUB ONLY, GAL-DEX™
25580	130800	INNER BEARING
LM67048	130000	OUTER BEARING
25520	136200	INNER RACE
LM67010	135400	OUTER RACE
10-1	159800	GREASE SEAL (3.376" O.D., 2.125" I.D.), SINGLE LIP
10-10	160000	GREASE SEAL (3.376" O.D., 2.125" I.D.), FOR E-Z LUBE®, DBL LIP
45896	151600	GREASE CAP, 2.44" O.D., DRIVE-IN
21-42-1	151800	GREASE CAP, 2.44" O.D., DRIVE-IN, FOR E-Z LUBE®
85-1	155400	GREASE CAP PLUG FOR E-Z LUBE®
7-122	144600	DRIVE-IN STUD, 1/2" DIAMETER, 2" LONG
7-150	144800	DRIVE-IN STUD, 1/2" DIAMETER, 2 1/4" LONG, ZINC
X1023R	140600	1/2" CONE WHEEL NUT

\*GAL-DEX™ Marine Hubs have Zinc Rich Galvanic Coating with Zinc Studs.



**New Marine Items!**



## 8 Bolt, 6.5" Bolt Circle

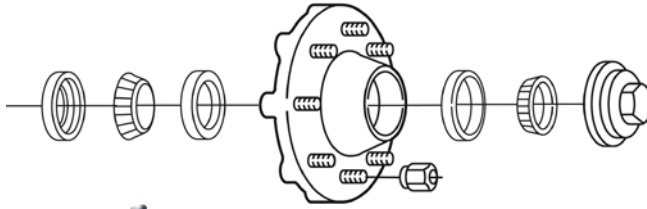

**New  
Marine  
Items!**

- **25580 Inner / 14125A Outer Bearings**
- Capacity of 3,500 lbs. per each
- Fits Dexter 5,200 lb. thru 7,000 lb. axles
- For Spindles requiring 2 1/8" or 2 1/4" I.D. Seals
- Std. Grease, E-Z LUBE® or Oil Bath Applications
- Std. Paint or "GAL-DEX™"\* corrosion resistant finish (Marine)
- For Idler applications only. See Page B-37 for Disc Brake Hubs & Components

PART NO.	REF. NO.	DESCRIPTION
42865UC1	110600	COMPLETE HUB ASSEMBLY, 2 1/4" I.D. SEAL, PAINTED
8-231-50UC1	111029	COMPLETE HUB ASSEMBLY, 2 1/4" I.D. SEAL, GAL-DEX™
42865UC1-EZ	110700	COMPLETE E-Z LUBE® HUB ASSEMBLY, 2 1/4" I.D. SEAL, PAINTED
8-231-50UC1-EZ	111032	COMPLETE E-Z LUBE® HUB ASSEMBLY, 2 1/4" I.D. SEAL, GAL-DEX™
42865	110400	HUB ONLY, PAINTED
8-231-50	111027	HUB ONLY, GAL-DEX™
8-231-9UC1	111000	COMPLETE HUB ASSEMBLY, 2 1/8" I.D. SEAL, PAINTED
8-231-9UC1-EZ	111025	COMPLETE E-Z LUBE® HUB ASSEMBLY, 2 1/8" I.D. SEAL, PAINTED
8-231-16UC1	111075	COMPLETE OIL BATH HUB ASSEMBLY, 2 1/8" I.D. SEAL, PAINTED
8-231-16UC1-225	111080	COMPLETE OIL BATH HUB ASSEMBLY, 2 1/4" I.D. SEAL, PAINTED
8-231-16	111050	HUB ONLY, OIL BATH, PAINTED
25580	130800	INNER BEARING
14125A	130600	OUTER BEARING
25520	136200	INNER RACE
14276	136200	OUTER RACE
10-1	159800	GREASE SEAL (3.376" O.D., 2.125" I.D.), SINGLE LIP
10-10	160000	GREASE SEAL (3.376" O.D., 2.125" I.D.), FOR E-Z LUBE®, DBL LIP
42385	159600	GREASE SEAL (3.376" O.D., 2.25" I.D.), SINGLE LIP
10-36	159700	GREASE SEAL (3.376" O.D., 2.25" I.D.), FOR E-Z LUBE®, DBL LIP
10-63	161225	OIL SEAL (3.376" O.D., 2.250" I.D.), UNITIZED
38605	152200	GREASE CAP, 2.72" O.D., DRIVE-IN, "DOME STYLE"
21-39	155300	GREASE CAP, 2.72" O.D., DRIVE-IN, "DERBY STYLE"
21-43-1	152400	GREASE CAP, 2.72" O.D., DRIVE-IN, FOR E-Z LUBE®
85-1	155400	GREASE CAP PLUG FOR E-Z LUBE®
RG04-230	150940	OIL CAP KIT, (21-35 CAP, 10-45 O-RING, 46-32 PLUG)
46-52	156000	OIL HUB PLUG
7-122	144600	DRIVE-IN STUD, 1/2" DIAMETER, 2" LONG
7-150	144800	DRIVE-IN STUD, 1/2" DIAMETER, 2 1/4" LONG, ZINC
X1023R	140600	1/2" CONE WHEEL NUT

\*GAL-DEX™ Marine Hubs have Zinc Rich Galvanic Coating with Zinc Studs.



**DEXTER AXLE**

## 8 Bolt, 6.5" Bolt Circle

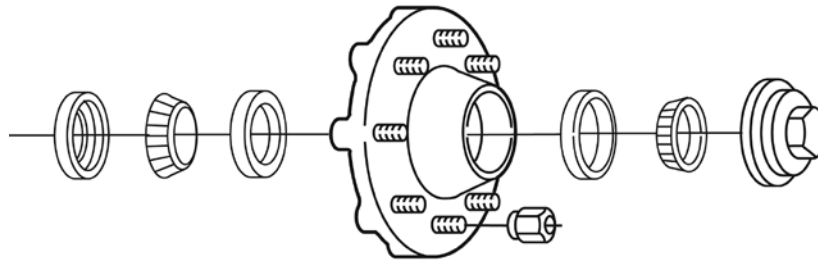

- **25580 Inner / 02475 Outer Bearings**
- Fits Dexter 8,000 lb. axles
- Hub comes with 9/16" studs, 5/8" with Special Order
- Oil Bath Hub
- For Idler applications only. See page B-38 for Disc Brake Hubs & Components

PART NO.	REF. NO.	DESCRIPTION
8-287-14UC1	111900	COMPLETE HUB ASSEMBLY (4.75" PILOT)
8-287-14	111875	HUB ONLY (4.75" PILOT)
25580	130800	INNER BEARING
02475	131000	OUTER BEARING
25520	136200	INNER RACE
02420	137000	OUTER RACE
10-63	161225	UNITIZED OIL SEAL (3.376" O.D., 2.250" I.D.)
RG04-230	150940	OIL CAP KIT, (21-35 CAP, 10-45 O-RING, 46-32 PLUG)
46-52	156000	OIL HUB PLUG
25-47	148600	SCREW-IN STUD, 9/16" DIAMETER
7-132	145200	DRIVE-IN STUD, 9/16" DIAMETER
7-115	145600	DRIVE-IN STUD, 5/8" DIAMETER (OPTIONAL)
6-53	140800	9/16" CONE WHEEL NUT
6-109	141000	5/8" CONE WHEEL NUT (OPTIONAL)



## Replacement Hub and Drum Assemblies

### 4 Bolt, 4" Bolt Circle

AXLE COMPONENTS

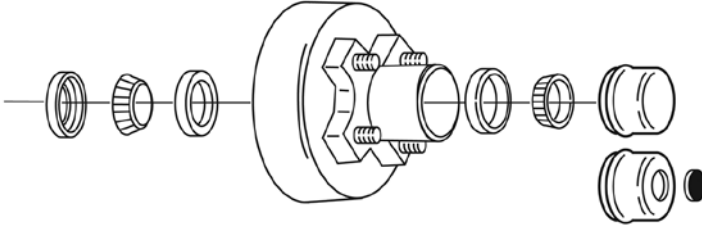

- **L44649 Inner / Outer Bearings**
- Fits Dexter 2,200 lb. Axles
- BTR 1-1/16" Spindle
- Std. Grease or E-Z LUBE® Application
- For 7 x 1.25" Electric Brake



PART NO.	REF. NO.	DESCRIPTION
8-173-16UC3	115435	COMPLETE HUB & DRUM ASSEMBLY
8-173-16UC3-EZ	115440	COMPLETE E-Z LUBE® HUB & DRUM ASSEMBLY
8-173-16	115930	HUB & DRUM ONLY
L44649	129000	INNER / OUTER BEARING
L44610	134400	INNER / OUTER RACE
10-9	158000	GREASE SEAL (1.987" O.D., 1.5" I.D.), SINGLE LIP
10-60	158200	GREASE SEAL (1.987" O.D., 1.5" I.D.) FOR E-Z LUBE®, DBL LIP
46749	151200	GREASE CAP, 1.986" O.D., DRIVE-IN
21-41-1	151400	GREASE CAP, 1.986" O.D., DRIVE-IN, FOR E-Z LUBE®
85-1	155400	GREASE CAP PLUG FOR E-Z LUBE®
09251510	144750	DRIVE-IN STUD, 1/2" DIAMETER
X1023R	140600	1/2" CONE WHEEL NUT

### 4 Bolt, 4" Bolt Circle

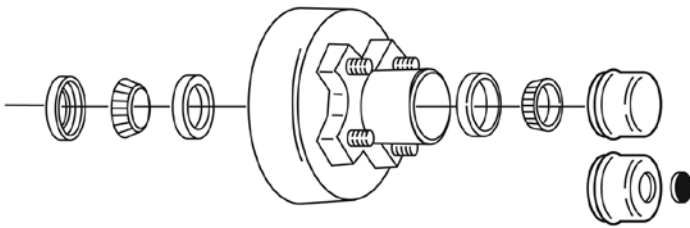

- **L44649 Inner / Outer Bearings**
- Fits Dexter 2,200 lb. axles
- BTR 1 1/16" Spindle
- Std. Grease or E-Z LUBE® application
- For 7 x 1.75" Hydraulic Brake



PART NO.	REF. NO.	DESCRIPTION
8-276-5UC3	115450	COMPLETE HUB & DRUM ASSEMBLY
8-276-5UC3-EZ	115455	COMPLETE E-Z LUBE® HUB & DRUM ASSEMBLY
8-276-5	115445	HUB & DRUM ONLY
L44649	129000	INNER / OUTER BEARING
L44610	134400	INNER / OUTER RACE
10-9	158000	GREASE SEAL (1.987" O.D., 1.5" I.D.), SINGLE LIP
10-60	158200	GREASE SEAL (1.987" O.D., 1.5" I.D.) FOR E-Z LUBE®, DBL LIP
46749	151200	GREASE CAP, 1.986" O.D., DRIVE-IN
21-41-1	151400	GREASE CAP, 1.986" O.D., DRIVE-IN, FOR E-Z LUBE®
85-1	155400	GREASE CAP PLUG FOR E-Z LUBE®
09251510	144750	DRIVE-IN STUD, 1/2" DIAMETER
X1023R	140600	1/2" CONE WHEEL NUT

## 5 Bolt, 4.5" Bolt Circle

- **L44643 Inner / Outer Bearings**
- Fits Dexter 2,200 lb. Axles
- BTR 1 1/16" Spindle
- Std. Grease or E-Z LUBE® Application
- For 7 x 1.25" Electric Brake

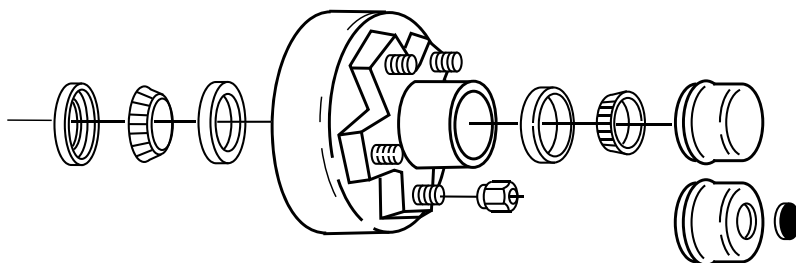

AXLE  
COMPONENTS

PART NO.	REF. NO.	DESCRIPTION
8-257-5UC3	116235	COMPLETE HUB & DRUM ASSEMBLY
8-257-5UC3-EZ	116240	COMPLETE E-Z LUBE® HUB & DRUM ASSEMBLY
8-257-5	116230	HUB & DRUM ONLY
L44649	129000	INNER / OUTER BEARING
L44610	134400	INNER / OUTER RACE
10-9	158000	GREASE SEAL (1.987" O.D., 1.5" I.D.), SINGLE LIP
10-60	158200	GREASE SEAL (1.987" O.D., 1.5" I.D.) FOR E-Z LUBE®, DBL LIP
46749	151200	GREASE CAP, 1.986" O.D., DRIVE-IN
21-41-1	151400	GREASE CAP, 1.986" O.D., DRIVE-IN, FOR E-Z LUBE®
85-1	155400	GREASE CAP PLUG FOR E-Z LUBE®
09251510	144750	DRIVE-IN STUD, 1/2" DIAMETER
X1023R	140600	1/2" CONE WHEEL NUT



## 5 Bolt, 4.5" Bolt Circle

- **L44649 Inner / Outer Bearings**
- Fits Dexter 2,200 lb. Axle, 1 1/16" Spindle
- Std. Grease or E-Z LUBE® application
- For 7 x 1.75" Hydraulic Brake

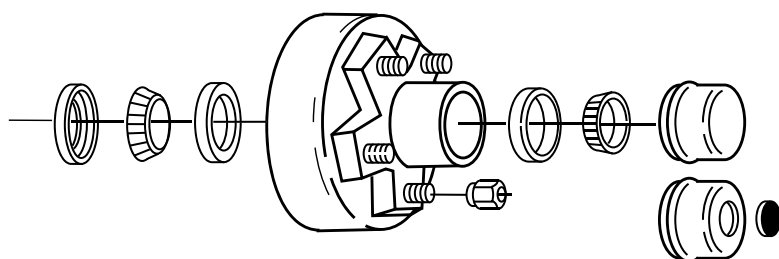

PART NO.	REF. NO.	DESCRIPTION
8-271-7U3C	116250	COMPLETE HUB & DRUM ASSEMBLY
8-271-7UC3-EZ	116255	COMPLETE E-Z LUBE® HUB & DRUM ASSEMBLY
8-271-7	116245	HUB & DRUM ONLY
L44649	129000	INNER / OUTER BEARING
L44610	134400	INNER / OUTER RACE
10-9	158000	GREASE SEAL, 1.987" O.D., 1.5" I.D., SINGLE LIP
10-60	158200	GREASE SEAL, 1.987" O.D., 1.5" I.D., FOR E-Z LUBE®, DBL LIP
46749	151200	GREASE CAP, 1.986" O.D., DRIVE-IN
21-41-1	151400	GREASE CAP, 1.986" O.D., DRIVE-IN, FOR E-Z LUBE®
85-1	155400	GREASE CAP PLUG FOR E-Z LUBE®
09251510	144750	DRIVE-IN STUD, 1/2" DIAMETER
X1023R	140600	1/2" CONE WHEEL NUT



## 5 Bolt, 4.5", 4.75", 5", 5.5" Bolt Circle

AXLE  
COMPONENTS

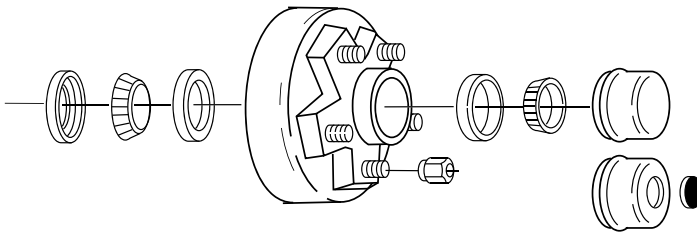

- Fits #84 Spindle, L68149 Inner / L44649 Outer Bearings
- Capacity of 1,750 lbs. per each
- Std. Grease or E-Z LUBE® application
- Used on Dexter and most 3,500 lb axles
- Drum Size: 10" x 2 1/4"
- 4 Different Bolt Patterns
- 5 on 4 1/2" available in Std. Paint or "GAL-DEX™" corrosion resistant finish (Marine)



New  
Marine  
Items!

PART NO.	REF. NO.	DESCRIPTION
84546UC3	116600	COMPLETE HUB & DRUM ASSEMBLY, 4.5" BOLT CIRCLE, PAINTED
8-247-50UC3	116635	COMPLETE HUB & DRUM ASSEMBLY, 4.5" BOLT CIRCLE, GAL-DEX™
84546UC3-EZ	116625	COMPLETE E-Z LUBE® HUB & DRUM ASSY, 4.5" BOLT CIRCLE, PAINTED
8-247-50UC3-EZ	116640	COMPLETE E-Z LUBE® HUB & DRUM ASSY, 4.5" BOLT CIRCLE, GAL-DEX™
84546	116400	HUB & DRUM ONLY, 4.5" BOLT CIRCLE, PAINTED
8-247-50	116630	HUB & DRUM ONLY, 4.5" BOLT CIRCLE, GAL-DEX™
845476UC3	117000	COMPLETE HUB & DRUM ASSEMBLY, 4.75" BOLT CIRCLE
845476UC3-EZ	117025	COMPLETE E-Z LUBE® HUB AND DRUM ASSEMBLY, 4.75" BOLT CIRCLE
845476	116800	HUB & DRUM ONLY, 4.75" BOLT CIRCLE
84556UC3	117400	COMPLETE HUB & DRUM ASSEMBLY, 5" BOLT CIRCLE
84556UC3-EZ	117425	COMPLETE E-Z LUBE® HUB & DRUM ASSEMBLY, 5" BOLT CIRCLE
84556	117200	HUB & DRUM ONLY, 5" BOLT CIRCLE
84557UC3	117800	COMPLETE HUB & DRUM ASSEMBLY, 5.5" BOLT CIRCLE
84557UC3-EZ	117825	COMPLETE E-Z LUBE® HUB & DRUM ASSEMBLY, 5.5" BOLT CIRCLE
84557	117600	HUB & DRUM ONLY, 5.5" BOLT CIRCLE
L68149	129200	INNER BEARING
L44649	129000	OUTER BEARING
L68111	135000	INNER RACE
L44610	134400	OUTER RACE
58846	158800	GREASE SEAL (2.565" O.D., 1.719" I.D.), SINGLE LIP
10-19	159000	GREASE SEAL (2.565" O.D., 1.719" I.D.) FOR E-Z LUBE®, DBL LIP
46749	151200	GREASE CAP, 1.986" O.D., DRIVE-IN
21-41-1	151400	GREASE CAP, 1.986" O.D., DRIVE-IN, FOR E-Z LUBE®
85-1	155400	GREASE CAP PLUG FOR E-Z LUBE®
7-122	144600	DRIVE-IN STUD, 1/2" DIAMETER, 2" LONG
7-150	144800	DRIVE-IN STUD, 1/2" DIAMETER, 2 1/4" LONG, ZINC
X1023R	140600	1/2" CONE WHEEL NUT

\*GAL-DEX™ Marine Hubs have Zinc Rich Galvanic Coating with Zinc Studs.

## 6 Bolt, 5.5" Bolt Circle

- Fits #84 Spindle, L68149 Inner / L44649 Outer Bearings
- Capacity of 1,750 lbs. per each
- Std. Grease or E-Z LUBE® application
- Used on Dexter and most 3,500 lb. axles
- Drum Size: 10" x 2 1/4"

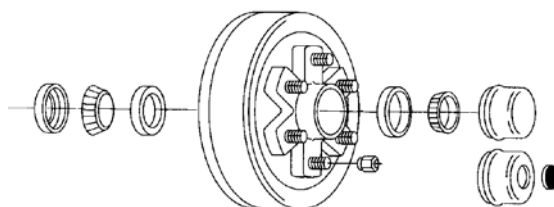

AXLE  
COMPONENTS

PART NO.	REF. NO.	DESCRIPTION
84656UC3	118200	COMPLETE HUB & DRUM ASSEMBLY
84656UC3-EZ	118225	COMPLETE E-Z LUBE® HUB & DRUM ASSEMBLY
84656	118000	HUB & DRUM ONLY



Components for this hub are the same as listed in the table on page B-20.

## 6 Bolt, 5.5" Bolt Circle

- L68149 Inner / LM67048 Outer Bearings
- Fits Dexter 4,400 lb. Axles
- Capacity of 2,200 lbs. per each
- Drum Size: 10" x 2 1/4"

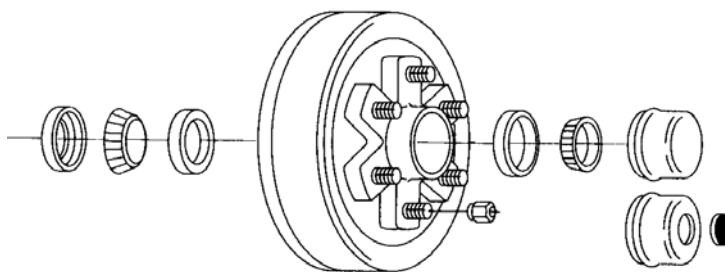

PART NO.	REF. NO.	DESCRIPTION
8-407-5UC3	118675	COMPLETE HUB & DRUM ASSEMBLY
8-407-5UC3-EZ	118680	COMPLETE E-Z LUBE® HUB & DRUM ASSEMBLY
8-407-5	118670	HUB & DRUM ONLY
L68149	129200	INNER BEARING
LM67048	130000	OUTER BEARING
L68111	135000	INNER RACE
LM67010	135400	OUTER RACE
58846	158800	GREASE SEAL (2.565" O.D., 1.719" I.D.), SINGLE LIP
10-19	159000	GREASE SEAL (2.565" O.D., 1.719" I.D.), FOR E-Z LUBE®, DBL LIP
45896	151600	GREASE CAP, 2.44" O.D., DRIVE-IN
21-42-1	151800	GREASE CAP, 2.44" O.D., DRIVE-IN, FOR E-Z LUBE®
85-1	155400	GREASE CAP PLUG FOR E-Z LUBE®
7-122	144600	DRIVE-IN STUD, 1/2" DIAMETER
X1023R	140600	1/2" CONE WHEEL NUT



## 6 Bolt, 5.5" Bolt Circle

AXLE  
COMPONENTS

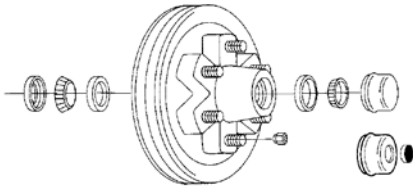

- #42 Spindle, 25580 Inner / 15123 Outer Bearings
- Fits Dexter 6,000 lb. Axles
- Capacity of 3,000 lbs. per each
- Std Grease or E-Z LUBE® Application
- For Spindles requiring 2 1/8" or 2 1/4" I.D. Grease Seal
- Drum Size: 12" x 2"
- Std. Paint or "GAL-DEX™" corrosion resistant finish (Marine)



New  
Marine  
Items!

PART NO.	REF. NO.	DESCRIPTION
42656UC3	119000	COMPLETE HUB/DRUM ASSEMBLY W/2 1/4" I.D. SEAL, PAINTED
8-201-51UC3	119160	COMPLETE HUB/DRUM ASSEMBLY W/2 1/4" I.D. SEAL, GAL-DEX™
42656UC3-EZ	119050	COMPLETE E-Z LUBE® HUB/DRUM ASSY W/2 1/4" I.D. SEAL, PAINTED
8-201-51UC3-EZ	119165	COMPLETE E-Z LUBE® HUB/DRUM ASSY W/2 1/4" I.D. SEAL, GAL-DEX™
8-201-9UC3	119100	COMPLETE HUB/DRUM ASSY W/2 1/8" I.D. SEAL
8-201-9UC3-EZ	119150	COMPLETE E-Z LUBE® HUB/DRUM ASSY W/2 1/8" I.D. SEAL
42656	118800	HUB & DRUM ONLY, PAINTED
8-201-51	11915	HUB & DRUM ONLY, GAL-DEX™
25580	130800	INNER BEARING
15123	130400	OUTER BEARING
25520	136200	INNER RACE
15245	135600	OUTER RACE
42385	159600	GREASE SEAL (3.376" O.D., 2.25" I.D.), SINGLE LIP
10-36	159700	GREASE SEAL (3.376" O.D., 2.25" I.D.), FOR E-Z LUBE®, DBL LIP
10-1	159800	GREASE SEAL (3.376" O.D., 2.125" I.D.), SINGLE LIP
10-10	160000	GREASE SEAL (3.376" O.D., 2.125" I.D.), FOR E-Z LUBE®, DBL LIP
45896	151600	GREASE CAP, 2.44" O.D., DRIVE-IN
21-42-1	151800	GREASE CAP, 2.44" O.D., DRIVE-IN, FOR E-Z LUBE®
85-1	155400	GREASE CAP PLUG FOR E-Z LUBE®
7-122	144600	DRIVE-IN STUD, 1/2" DIA. X 1.99" LONG
165995	145000	DRIVE-IN STUD, 1/2" DIA. X 2.50" LONG
7-262	145001	DRIVE-IN STUD, 1/2" DIA. X 2.70" LONG
7-262-1	145002	DRIVE-IN STUD, 1/2" DIA. X 2.70" LONG, ZINC
X1023R	140600	1/2" CONE WHEEL NUT

\*GAL-DEX™ Marine Hubs have Zinc Rich Galvanic Coating with Zinc Studs.

## 6 Bolt, 5.5" Bolt Circle

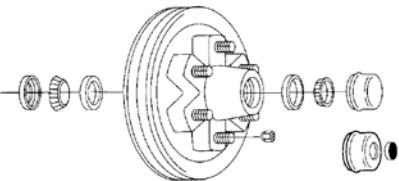

- 25580 Inner / LM67048 Outer Bearings
- Fits Dexter 5,200 lb. Axles
- Capacity of 2,600 lbs. per each
- Std. Grease or E-Z LUBE® application
- Drum Size: 12" x 2"
- Std. Paint or "GAL-DEX™" corrosion resistant finish (Marine)



New  
Marine  
Items!

PART NO.	REF. NO.	DESCRIPTION
8-201-5UC3	119400	COMPLETE HUB & DRUM ASSEMBLY, PAINTED
8-201-50UC3	119435	COMPLETE HUB & DRUM ASSEMBLY, GAL-DEX™
8-201-5UC3-EZ	119425	COMPLETE E-Z LUBE® HUB & DRUM ASSEMBLY, PAINTED
8-201-50UC3-EZ	119440	COMPLETE E-Z LUBE® HUB & DRUM ASSEMBLY, GAL-DEX™
8-201-5	119200	HUB & DRUM ONLY, PAINTED
8-201-50	119430	HUB & DRUM ONLY, GAL-DEX™
25580	130800	INNER BEARING
LM67048	130000	OUTER BEARING
25520	136200	INNER RACE
LM67010	135400	OUTER RACE
10-1	159800	GREASE SEAL (3.376" O.D., 2.125" I.D.), SINGLE LIP
10-10	160000	GREASE SEAL (3.376" O.D., 2.125" I.D.), FOR E-Z LUBE®, DBL LIP
45896	151600	GREASE CAP, 2.44" O.D., DRIVE-IN
21-42-1	151800	GREASE CAP, 2.44" O.D., DRIVE-IN, FOR E-Z LUBE®
85-1	155400	GREASE CAP PLUG FOR E-Z LUBE®
7-122	144600	DRIVE-IN STUD, 1/2" DIA. X 1.99" LONG
165995	145000	DRIVE-IN STUD, 1/2" DIA. X 2.50" LONG
7-262	145001	DRIVE-IN STUD, 1/2" DIA. X 2.70" LONG
7-262-1	145002	DRIVE-IN STUD, 1/2" DIA. X 2.70" LONG, ZINC
X1023R	140600	1/2" CONE WHEEL NUT

\*GAL-DEX™ Marine Hubs have Zinc Rich Galvanic Coating with Zinc Studs.

## 5 Spoke, Utility Type (Grease & Oil)

- **5580 Inner / 15123 Outer Bearings**
- Fits Dexter 6,000 lb. and 7,000 lb. Axles
- Capacity of 3,500 lbs. per each
- Drum Size: 12" x 2"
- For spindles requiring 2 1/8" or 2 1/4" I.D. Seals
- Std. Grease, E-Z LUBE® or Oil Bath application

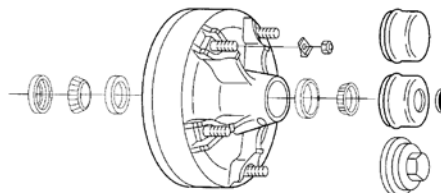

AXLE  
COMPONENTS

PART NO.	REF. NO.	DESCRIPTION
8-174-5UC3	121000	COMPLETE HUB & DRUM ASSEMBLY, GREASE, 2 1/8" I.D. SEAL
8-174-5UC3-EZ	121010	COMPLETE E-Z LUBE® HUB & DRUM ASSEMBLY, GREASE, 2 1/8" I.D. SEAL
8-174-5UC3-225	121015	COMPLETE HUB & DRUM ASSEMBLY, GREASE, 2 1/4" I.D. SEAL
8-174-5UC3EZ-225	121020	COMPLETE E-Z LUBE® HUB & DRUM ASSEMBLY, GREASE - 2 1/4" I.D. SEAL
8-174-5	120800	HUB & DRUM ONLY, GREASE
8-174-6UC3	121050	COMPLETE OIL BATH HUB & DRUM ASSEMBLY, 2 1/8" I.D. SEAL
8-174-6UC3-225	121055	COMPLETE OIL BATH HUB & DRUM ASSEMBLY, 2 1/4" I.D. SEAL
8-174-6	121025	HUB & DRUM ONLY, OIL BATH
25580	130800	INNER BEARING
15123	130400	OUTER BEARING
25520	136200	INNER RACE
15245	135600	OUTER RACE
42385	159600	GREASE SEAL (3.376" O.D., 2.250" I.D.), SINGLE LIP
10-36	159700	GREASE SEAL (3.376" O.D., 2.250" I.D.), FOR E-Z LUBE®, DBL LIP
10-1	159800	GREASE SEAL (3.376" O.D., 2.125" I.D.), SINGLE LIP
10-10	160000	GREASE SEAL (3.376" O.D., 2.125" I.D.), FOR E-Z LUBE® & OIL BATH, DBL LIP
10-63	161225	OIL SEAL, (3.376" O.D., 2.250" I.D.), UNITIZED
45896	151600	GREASE CAP, 2.44" O.D., DRIVE-IN
21-42-1	151800	GREASE CAP, 2.44" O.D., DRIVE-IN, FOR E-Z LUBE®
85-1	155400	GREASE CAP PLUG FOR E-Z LUBE®
RG04-260	150950	OIL CAP KIT, (21-40 CAP, 10-59 O-RING)
10-59	156825	O-RING GASKET FOR 21-40 OIL CAP
46-52	156000	OIL HUB PLUG
15-2	149600	RIM CLAMP
25-11	148200	SCREW-IN STUD, 9/16" DIAMETER
916N	078400	9/16" WHEEL NUT

## 8 Bolt, 6.5" Bolt Circle

- **Fits #99 Spindle, 28580 Inner / 25580 Outer Bearing**
- Drum Size: 12" x 2"

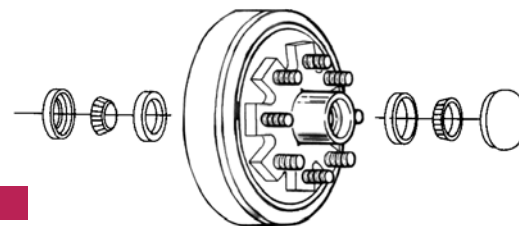

PART NO.	REF. NO.	DESCRIPTION
99865UC3	121400	COMPLETE HUB & DRUM ASSEMBLY
99865	121200	HUB & DRUM ONLY
28580	132200	INNER BEARING
25580	130800	OUTER BEARING
28521	136800	INNER RACE
25520	136200	OUTER RACE
T51153	160200	GREASE SEAL (3.623" O.D., 2.375" I.D.), SINGLE LIP
75DC	153000	GREASE CAP, 3.375" O.D. DRIVE-IN
165995	145000	DRIVE-IN STUD, 1/2" DIA. X 2-1/2" LONG
X1023R	140600	1/2" CONE WHEEL NUT

## 8 Bolt, 6.5" Bolt Circle

AXLE  
COMPONENTS

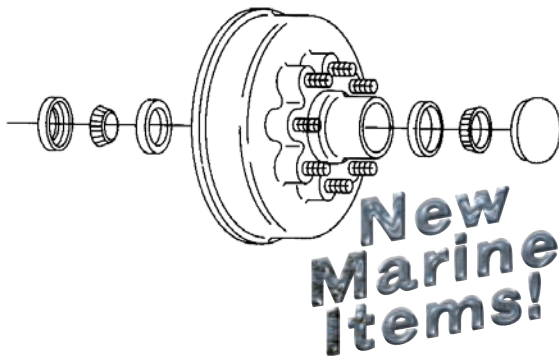

**New  
Marine  
Items!**

- #42 Spindle, 25580 Inner / 14125A Outer Bearings
- Fits Dexter 5,200 lb. thru 7,000 lb. Axles
- Capacity of 3,500 lbs. per each
- For Spindles requiring 2 1/4" or 2 1/8" I.D. Seal
- Drum Size 12" x 2"
- Std. Grease, E-Z LUBE® or Oil Bath applications
- 1/2" Studs Standard (9/16" & 5/8" available as special order)
- Std. Paint or "GAL-DEX™" corrosion resistant finish (Marine)

PART NO.	REF. NO.	DESCRIPTION
42866UC3	119800	COMPLETE HUB & DRUM ASSEMBLY W/ 2 1/4" I.D. SEAL, PAINTED
8-219-50UC3	120235	COMPLETE HUB & DRUM ASSEMBLY W/ 2 1/4" I.D. SEAL, GAL-DEX™
42866UC3-EZ	119810	COMPLETE E-Z LUBE® HUB & DRUM ASSEMBLY W/ 2 1/4" I.D. SEAL, PAINTED
8-219-50UC3-EZ	120240	COMPLETE E-Z LUBE® HUB & DRUM ASSEMBLY W/ 2 1/4" I.D. SEAL, GAL-DEX™
8-219-4UC3	120200	COMPLETE HUB & DRUM ASSEMBLY W/ 2 1/8" I.D. SEAL
8-219-4UC3-EZ	120225	COMPLETE E-Z LUBE® HUB & DRUM ASSEMBLY W/ 2 1/8" I.D. SEAL
42866	119600	HUB & DRUM ONLY, GREASE/E-Z LUBE®, PAINTED
8-219-50	120230	HUB & DRUM ONLY, GREASE/E-Z LUBE®, GAL-DEX™
8-219-9UC3	120275	COMPLETE OIL BATH HUB & DRUM ASSEMBLY W/ 2 1/8" I.D. SEAL
8-219-9UC3-A	120280	COMPLETE OIL BATH HUB & DRUM ASSEMBLY W/ 2 1/4" I.D. SEAL
8-219-9	120250	HUB & DRUM ONLY, OIL BATH
25580	130800	INNER BEARING
14125A	130600	OUTER BEARING
25520	136200	INNER RACE
14276	135800	OUTER RACE
42385	159600	GREASE SEAL (3.376" O.D., 2.25" I.D.), SINGLE LIP
10-36	159700	GREASE SEAL (3.376" O.D., 2.25" I.D.), FOR E-Z LUBE®, DOUBLE LIP
10-1	159800	GREASE SEAL (3.376" O.D., 2.125" I.D.), SINGLE LIP
10-10	160000	SEAL (3.376" O.D., 2.125" I.D.), FOR E-Z LUBE® & OIL BATH, DOUBLE LIP
10-63	161225	UNITIZED OIL SEAL (3.376" O.D., 2.25" I.D.)
38605	152200	GREASE CAP, 2.72" O.D., DRIVE-IN, "DOME STYLE"
21-39	155300	GREASE CAP, 2.72" O.D., DRIVE-IN, "DERBY STYLE"
21-43-1	152400	GREASE CAP FOR E-Z LUBE®
85-1	155400	GREASE CAP PLUG FOR E-Z LUBE®
RG04-230	150940	OIL CAP KIT, (21-25 CAP, 10-45 O-RING, 46-32 PLUG)
46-52	156000	OIL HUB PLUG
7-122	144600	DRIVE-IN STUD, 1/2" DIA. X 1.99" LONG
165995	145000	DRIVE-IN STUD, 1/2" DIA. X 2.50" LONG
7-262	145001	DRIVE-IN STUD, 1/2" DIA. X 2.70" LONG
7-262-1	145002	DRIVE-IN STUD, 1/2" DIA. X 2.70" LONG, ZINC
X1023R	140600	1/2" CONE WHEEL NUT

\*GAL-DEX™ Marine Hubs have Zinc Rich Galvanic Coating with Zinc Studs.

## 8 Bolt, 6.5" Bolt Circle

- **25580 Inner / 02475 Outer Bearings**
- Fits Dexter 7,200 lb. Axles
- Oil Bath, Grease or E-Z LUBE®
- Hub comes with  $\frac{9}{16}$ " or  $\frac{5}{8}$ " studs
- Drum Size: 12  $\frac{1}{4}$ " x 2  $\frac{1}{2}$ "

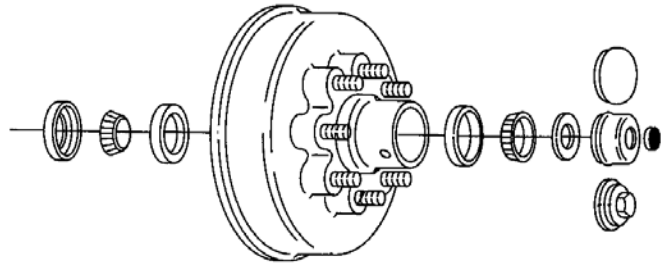

In February 2000, the 7,200 lb. axle was upgraded from a 9-bolt to a 4-bolt brake flange. Be sure to verify flange type before making your selection, hub/drums will not interchange.

PART NO.	REF. NO.	DESCRIPTION
8-355-12	122355	HUB & DRUM ONLY, OIL BATH, 9/16" STUD (9-BOLT FLANGE)
8-355-12UC3	122360	COMPLETE HUB & DRUM ASSEMBLY, OIL BATH 9/16" STUD (9-BOLT FLANGE)
8-393-3	122361	HUB & DRUM ONLY, OIL BATH, 9/16" STUD (4-BOLT FLANGE)
8-393-3UC3	122362	COMPLETE HUB & DRUM ASSEMBLY, OIL BATH, 9/16" STUD (4-BOLT FLANGE)
8-355-13	122363	HUB & DRUM ONLY, GREASE, 9/16" STUD (9-BOLT FLANGE)
8-355-13UC3	122365	COMPLETE HUB & DRUM ASSEMBLY, GREASE, 9/16" STUD (9-BOLT FLANGE)
8-355-13UC3-EZ	122370	COMPLETE E-Z LUBE® HUB & DRUM ASSEMBLY, GREASE, 9/16" STUD (9-BOLT FLANGE)
8-393-4	122375	HUB & DRUM ONLY, GREASE, 9/16" STUD (4-BOLT FLANGE)
8-393-4UC3	122377	COMPLETE HUB & DRUM ASSEMBLY, GREASE, 9/16" STUD (4-BOLT FLANGE)
8-393-4UC3-EZ	122380	COMPLETE E-Z LUBE® HUB & DRUM ASSEMBLY, GREASE, 9/16" STUD (4-BOLT FLANGE)
8-355-14	122425	HUB & DRUM ONLY, OIL BATH, 5/8" STUD (9-BOLT FLANGE)
8-355-14UC3-A	122430	COMPLETE HUB & DRUM ASSEMBLY, OIL BATH, 5/8" FLG NUTS (9-BOLT FLANGE)
8-355-14UC3-B	122435	COMPLETE HUB & DRUM ASSEMBLY, OIL BATH, 5/8" CONE NUTS (9-BOLT FLANGE)
8-393-5	122436	HUB & DRUM ONLY, OIL BATH, 5/8" STUD (4-BOLT FLANGE)
8-393-5UC3-A	122437	COMPLETE HUB & DRUM ASSEMBLY, OIL BATH, 5/8" FLG NUTS (4-BOLT FLANGE)
8-393-5UC3-B	122438	COMPLETE HUB & DRUM ASSEMBLY, OIL BATH, 5/8" CONE NUTS (4-BOLT FLANGE)
8-355-15	122440	HUB & DRUM ONLY, GREASE, 5/8" STUD (9-BOLT FLANGE)
8-355-15UC3-A	122445	COMPLETE HUB & DRUM ASSEMBLY, GREASE, 5/8" FLG NUTS (9-BOLT FLANGE)
8-355-15UC3-B	122450	COMPLETE HUB & DRUM ASSEMBLY, GREASE, 5/8" CONE NUTS (9-BOLT FLANGE)
8-355-15UC3-EZA	122455	COMPLETE E-Z LUBE® HUB & DRUM ASSEMBLY, GREASE, 5/8" FLG NUTS (9-BOLT FLANGE)
8-355-15UC3-EZB	122460	COMPLETE E-Z LUBE® HUB & DRUM ASSEMBLY, GREASE, 5/8" CONE NUTS (9-BOLT FLANGE)
8-393-6	122462	HUB & DRUM ONLY, GREASE, 5/8" STUD (4-BOLT FLANGE)
8-393-6UC3-A	122463	COMPLETE HUB & DRUM ASSEMBLY, GREASE, 5/8" FLG NUTS (4-BOLT FLANGE)
8-393-6UC3-B	122464	COMPLETE HUB & DRUM ASSEMBLY, GREASE, 5/8" CONE NUTS (4-BOLT FLANGE)
8-393-6UC3-EZA	122465	COMPLETE E-Z LUBE® HUB & DRUM ASSEMBLY, GREASE, 5/8" FLG NUTS (4-BOLT FLANGE)
8-393-6UC3-EZB	122466	COMPLETE E-Z LUBE® HUB & DRUM ASSEMBLY, GREASE, 5/8" CONE NUTS (4-BOLT FLANGE)
25580	130800	INNER BEARING
02475	131000	OUTER BEARING
10-63	161225	UNITIZED OIL SEAL (3.376" O.D., 2.250" I.D.)
21-43-1	152400	GREASE CAP, 2.72" O.D. DRIVE-IN FOR E-Z LUBE®
38605	152200	GREASE CAP, 2.72" O.D., DRIVE-IN, "DOME STYLE"
21-39	155300	GREASE CAP, 2.72" O.D., DRIVE-IN, "DERBY STYLE"
RG04-230	150940	OIL CAP KIT, (21-35 CAP, 10-45 O-RING, 46-32 PLUG)
85-1	155400	GREASE CAP PLUG, FOR ALL E-Z LUBE® GREASE CAPS
7-223	145300	DRIVE-IN STUD, 9/16" DIAMETER
7-224	145350	DRIVE-IN STUD, 5/8" DIAMETER
6-53	140800	9/16" CONE WHEEL NUT
6-109	141000	5/8" CONE WHEEL NUT
95188	141600	5/8" FLANGE WHEEL NUT

## 8 Bolt, 6.5" Bolt Circle

AXLE  
COMPONENTS

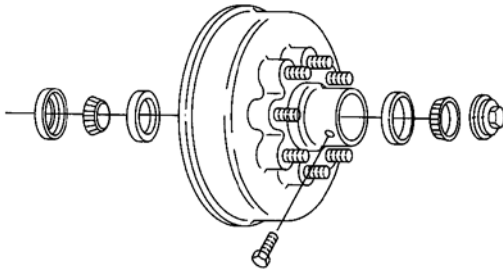

- **25580 Inner / 02475 Outer Bearings**
- Fits Dexter 7,500 lb. Axles
- Oil Bath Hub and Drum, 5/8" Stud
- Drum Size: 12" x 3"
- Drum no longer available, parts only



PART NO.	REF. NO.	DESCRIPTION
25580	130800	INNER BEARING
02475	131000	OUTER BEARING
25520	136200	INNER RACE
02420	137000	OUTER RACE
10-63	161225	UNITIZED OIL SEAL (3.376" O.D., 2.250" I.D.)
RG04-230	150940	OIL CAP KIT, (21-35 CAP, 10-45 O-RING, 46-32 PLUG)
46-52	156000	OIL HUB PLUG
25-48	148800	SCREW-IN STUD, 5/8" DIAMETER
6-109	141000	5/8" CONE WHEEL NUT

## 8 Bolt, 6.5" Bolt Circle

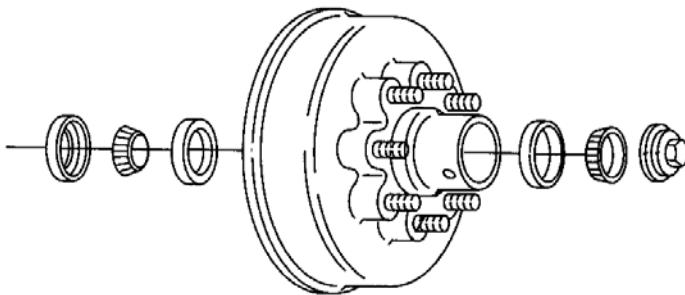

- **25580 Inner / 02475 Outer Bearings**
- Fits AL-KO/Hayes 8,000 lb. Axles
- Drum Size: 12" x 3 1/4" (upgraded to 12" x 3 3/8")
- Oil Bath Hub & Drum
- 9/16" Studs, 4.75" Hub Pilot (5/8" Special Order)

PART NO.	REF. NO.	DESCRIPTION
9080648UC3	122325	COMPLETE HUB & DRUM ASSEMBLY
9080648	122300	HUB & DRUM ONLY (AL-KO# 363694)
25580	130800	INNER BEARING
02475	131000	OUTER BEARING
25520	136200	INNER RACE
02420	137000	OUTER RACE
RG04-280	150960	OIL CAP KIT, (NEW STYLE, AFTER 01/97), (92128 CAP, 9103501 GASKET, 92126 PLUG)
RG04-290	150965	OIL CAP KIT, (OLD STYLE, BEFORE 01/97), (9212801 CAP, 9103501 GASKET, 92126 PLUG)
10-63	161225	UNITIZED OIL SEAL, 3.376" O.D., 2.25" I.D.
6-53	140800	9/16" CONE WHEEL NUT

## 8 Bolt, 6.5" Bolt Circle

- 25580 Inner / 02475 Outer Bearings
- Fits Dexter 8,000 lb. Axles
- Oil Bath or E-Z LUBE®
- Hub comes with 9/16" or 5/8" studs
- 4.56" (Old Style) or 4.75" (New Style) Hub Pilot
- Drum Size: 12 1/4" x 3 3/8"
- Available with or without ABS exciter ring installed.

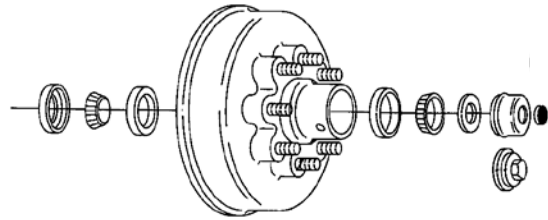

AXLE COMPONENTS

Standard Hub / Drums			ABS Hubs / Drums	
PART NO.	REF. NO.	DESCRIPTION	PART NO.	REF. NO.
8-218-9	122575	HUB & DRUM ONLY (4.56" PILOT) OIL BATH - 9/16" STUDS	N/A	N/A
8-218-9UC3	122600	COMPLETE HUB & DRUM ASSEMBLY (4.56" PILOT) OIL BATH - 9/16" STUDS	N/A	N/A
8-285-8	123010	HUB & DRUM ONLY, (4.75" PILOT) E-Z LUBE® - 5/8" STUDS	8-285-15	123096
8-285-8UC3-A	123015	COMPLETE HUB & DRUM ASSEMBLY (4.75" PILOT) E-Z LUBE®, 5/8" STUDS & 95188 NUT	8-285-15UC3-A	123098
8-285-8UC3-B	123020	COMPLETE HUB & DRUM ASSEMBLY (4.75" PILOT) E-Z LUBE®, 5/8" STUDS & 6-109 NUT	8-285-15UC3-B	123099
8-285-9	123025	HUB & DRUM ONLY (4.75" PILOT) OIL BATH - 9/16" STUDS	8-285-12	123082
8-285-9UC3	123050	COMPLETE HUB & DRUM ASSEMBLY (4.75" PILOT) OIL BATH - 9/16" STUDS	8-285-12UC3	123084
8-285-10	123055	HUB & DRUM ONLY, (4.75" PILOT), OIL BATH - 5/8" STUDS	8-285-14	123090
8-285-10UC3-A	123060	COMPLETE HUB & DRUM ASSEMBLY (4.75" PILOT) OIL BATH, 5/8" STUDS & 95188 NUT	8-285-14UC3-A	123092
8-285-10UC3-B	123065	COMPLETE HUB & DRUM ASSEMBLY (4.75" PILOT) OIL BATH, 5/8" STUDS & 6-109 NUT	8-285-14UC3-B	123094
8-285-11	123075	HUB & DRUM ONLY (4.75" PILOT) E-Z LUBE® - 9/16" STUDS	8-285-13	123086
8-285-11UC3	123080	COMPLETE HUB & DRUM ASSEMBLY (4.75" PILOT) E-Z LUBE® 9/16" STUDS	8-285-13UC3	123088



Replacement Components		
PART NO.	REF. NO.	DESCRIPTION
25580	130800	INNER BEARING
02475	131000	OUTER BEARING
25520	136200	INNER RACE
02420	137000	OUTER RACE
10-63	161225	UNITIZED OIL SEAL (3.376" O.D., 2.250" I.D.)
10-36	159700	GREASE SEAL, DOUBLE LIP, (3.376" O.D., 2.25" I.D.), FOR E-Z LUBE®
21-43-1	152400	GREASE CAP, 2.72" O.D. DRIVE-IN FOR E-Z LUBE®
85-1	155400	GREASE CAP PLUG, FOR ALL E-Z LUBE® GREASE CAPS
RG04-230	150940	OIL CAP KIT, (31-35 CAP, 10-45 O-RING, 46-32 PLUG)
7-132	145200	DRIVE-IN STUD, 9/16" DIAMETER
7-232	145400	DRIVE-IN STUD, 5/8" DIAMETER
6-53	140800	9/16" CONE WHEEL NUT
6-109	141000	5/8" CONE WHEEL NUT
95188	141600	5/8" FLANGE WHEEL NUT

## 8 Bolt, 6.5" Bolt Circle

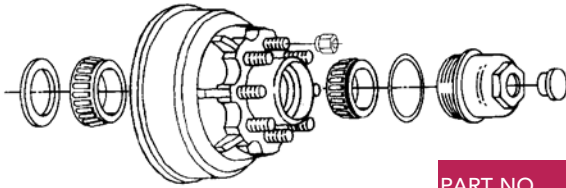

- Fits #99 Spindle, 28580 Inner / 25580 Outer Bearings
- Oil Bath Hub (coined Dual Wheel), AL-KO/Hayes
- Drum Size: 12 1/4" x 3 1/2"

PART NO.	REF. NO.	DESCRIPTION
9080568UC3	121800	COMPLETE HUB & DRUM ASSEMBLY
9080568	121600	HUB & DRUM ONLY (COINED) W/ARMATURE PLATE
28580	132200	INNER BEARING
25580	130800	OUTER BEARING
28521	136800	INNER RACE
25520	136200	OUTER RACE
91030	163000	OIL SEAL, (3.779" O.D., 2.750" I.D.), UNITIZED
RG04-250	150945	OIL CAP KIT, (92125 CAP, 92126 PLUG, 9103502 GASKET)
090737	145800	DRIVE-IN STUD, 5/8" DIAMETER, 2 13/16" LONG
95188	141600	5/8" FLANGED WHEEL NUT

## 8 Bolt, 6.5" Bolt Circle

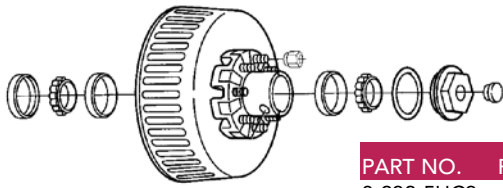

- Oil Bath Hub, 25580 Inner / 2585 Outer Bearing
- Fits Dexter 9K Axles, "Old Style", MFG up to 10-01-89
- Drum Size: 12 1/4" x 3 3/8"
- 4.75" Hub Pilot

PART NO.	REF. NO.	DESCRIPTION
8-232-5UC3	123000	COMPLETE HUB & DRUM ASSEMBLY (4.56" PILOT)
8-232-5	122800	HUB & DRUM ONLY (4.56" PILOT)
8-286-5UC3	122650	COMPLETE HUB & DRUM ASSEMBLY (4.75" PILOT)
8-286-5	122625	HUB & DRUM ONLY (4.75" PILOT, MFG 04-15 THROUGH 10-01-89)
25580	130800	INNER BEARING
2585	131200	OUTER BEARING
25520	136200	INNER RACE
2520	137200	OUTER RACE
10-63	161225	UNITIZED OIL SEAL (3.376" O.D., 2.25" I.D.)
RG04-230	150940	OIL CAP KIT, (21-35 CAP, 10-45 O-RING, 46-32 PLUG)
7-115	145600	DRIVE-IN STUD, 5/8" DIAMETER
33-52-1	142800	WHEEL RETAINING RING
6-109	141000	5/8" CONE WHEEL NUT



## 8 Bolt, 6.5" Bolt Circle

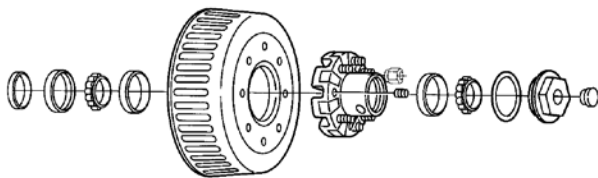

- Oil Bath Hub, 387A Inner / 25580 Outer Bearing
- Fits Dexter 9K (after 10/89) and 10K General Duty
- "Old Style" 2-piece Hub & Drum through 07-01-09
- Capacity of 5,000 lbs. per each
- Drum Size: 12 1/4" x 3 3/8"
- Drum Available with ABS exciter ring installed
- 4.75" Hub Pilot

PART NO.	REF. NO.	DESCRIPTION
8-288-3UC1	111920	COMPLETE HUB ASSEMBLY (BRAKE DRUM & MTG BOLTS NOT INCL.)
8-288-3	111910	HUB ONLY
9-44-1	124390	BRAKE DRUM ONLY, NON-ABS
9-44-3	124395	BRAKE DRUM ONLY, W/ ABS EXCITER RING
7-245	150500	DRUM MOUNTING BOLT
387A	131400	INNER BEARING
25580	130800	OUTER BEARING
382A	137400	INNER RACE
25520	136200	OUTER RACE
10-51	161650	UNITIZED OIL SEAL, (3.88" O.D., 2.875" I.D.)
RG04-270	150955	OIL CAP KIT (21-36 CAP, 10-50 O-RING, 46-32 PLUG)
7-115	145600	DRIVE-IN STUD, 5/8" DIAMETER
33-52-1	142800	WHEEL RETAINING RING
6-109	141000	5/8" CONE WHEEL NUT



## 8 Bolt, 6.5" Bolt Circle

- **Oil Bath Hub, 387A Inner / 25580 Outer Bearing**
- Fits Dexter 9K & 10K General Duty (After 07-01-09)
- One-Piece Hub & Drum
- Capacity of 5,000 lbs. per each
- Drum Size: 12 1/4" x 3 3/8"
- Available with ABS exciter ring installed
- 4.75" Hub Pilot

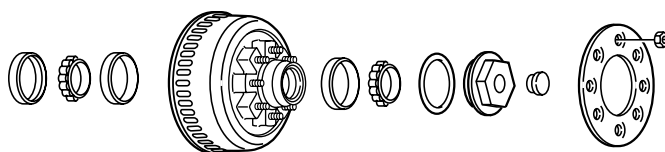

AXLE  
COMPONENTS

PART NO.	REF. NO.	DESCRIPTION
8-415-2UC3	123210	COMPLETE HUB & DRUM ASSEMBLY, NON-ABS
8-415-2	123200	HUB & DRUM ONLY, NON-ABS
8-415-4UC3	123230	COMPLETE HUB & DRUM ASSEMBLY, ABS
8-415-4	123220	HUB & DRUM ONLY, W/ABS EXCITER RING
387A	131400	INNER BEARING
25580	130800	OUTER BEARING
382A	137400	INNER RACE
25520	136200	OUTER RACE
10-51	161650	UNITIZED OIL SEAL (3.88" O.D., 2.875" I.D.)
RG04-300	190157	OIL CAP KIT (21-88 CAP, 10-163 O-RING, 46-32 PLUG)
7-115	145600	DRIVE-IN STUD, 5/8" DIAMETER
33-52-1	142800	WHEEL RETAINING RING
6-109	141000	5/8" CONE WHEEL NUT



## 8 Bolt, 6.5" Bolt Circle

- **Oil Bath Hub, 395S Inner / 387A Outer Bearing**
- Fits Dexter 10K Axles
- Capacity of 5,000 lbs. per each
- Drum Size: 12 1/4" x 4"
- Drum Available with ABS exciter ring installed
- 4.75" Hub Pilot

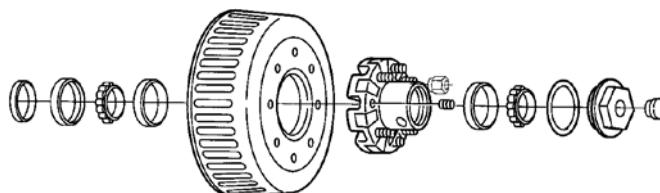

PART NO.	REF. NO.	DESCRIPTION
8-214-5UC1	112200	COMPLETE HUB ASSEMBLY (BRAKE DRUM & MTG BOLTS NOT INCL.)
8-214-5	112000	HUB ONLY
9-27-1	124400	BRAKE DRUM ONLY, NON-ABS
9-27-3	124405	BRAKE DRUM ONLY, W/ ABS EXCITER RING
7-244	150600	DRUM MOUNTING BOLT
395S	131600	INNER BEARING
387A	131400	OUTER BEARING
394A	137600	INNER RACE
382A	137400	OUTER RACE
10-56	162000	UNITIZED OIL SEAL, (4.50" O.D., 3.125" I.D.)
RG04-270	150955	OIL CAP KIT (21-36 CAP, 10-50 O-RING, 46-32 PLUG)
7-115	145600	DRIVE-IN STUD, 5/8" DIAMETER
33-52-1	142800	WHEEL RETAINING RING
6-109	141000	5/8" CONE WHEEL NUT



## 8 Bolt, 6.5" Bolt Circle

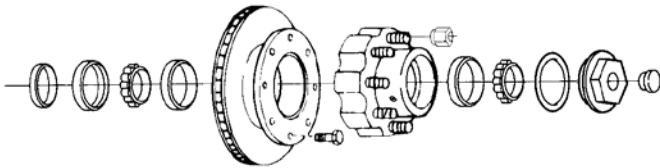

- **Oil Bath Hub, 395S Inner / 387A Outer Bearings**
- Fits Dexter 10K Disc Brake Axles
- Capacity of 5,000 lbs. per each
- Rotor Available with ABS exciter ring installed
- 4.75" Hub Pilot



PART NO.	REF. NO.	DESCRIPTION
8-214-6UC1	112220	COMPLETE HUB ASSEMBLY (ROTOR & MTG HARDWARE NOT INCL.)
8-214-6	112210	HUB ONLY
70-006	124950	BRAKE ROTOR ONLY, NON-ABS
70-006-2	124955	BRAKE ROTOR ONLY, W/ ABS EXCITER RING
6-46	193000	ROTOR MOUNTING NUT
395S	131600	INNER BEARING
387A	131400	OUTER BEARING
394A	137600	INNER RACE
382A	137400	OUTER RACE
10-56	162000	UNITIZED OIL SEAL, (4.50" O.D., 3.125" I.D.)
RG04-270	150955	OIL CAP KIT (21-36 CAP, 10-50 O-RING, 46-32 PLUG)
7-115	145600	DRIVE-IN STUD, 5/8" DIAMETER
33-52-1	142800	WHEEL RETAINING RING
6-109	141000	5/8" CONE WHEEL NUT

## 8 Bolt, 6.5" Bolt Circle

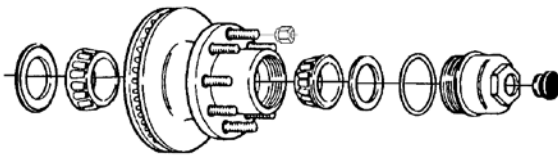

- **Oil Bath Hub, JM511946 Inner / JM205149 Outer Bearing**
- Fits AL-KO/Hayes 10K Disc Brake Axles
- Capacity of 5,000 lbs. per each
- For use w/coined dual wheels

PART NO.	REF. NO.	DESCRIPTION
090814UC3	125200	COMPLETE HUB & ROTOR ASSEMBLY
090814	125000	HUB & ROTOR ONLY
JM511946	132800	INNER BEARING
JM205149	132600	OUTER BEARING
JM511910	138400	INNER RACE
JM205110	138200	OUTER RACE
10-56	162000	UNITIZED OIL SEAL, (4.50" O.D., 3.125" I.D.)
RG04-250	150945	OIL CAP KIT, (92125 CAP, 92126 PLUG, 92127 O-RING, 9103502 GASKET)
090737	145800	DRIVE-IN STUD, 5/8" DIAMETER
95188	141600	5/8" FLANGED WHEEL NUT

## 8 Bolt, 6.5" Bolt Circle

- **Oil Bath Hub, 3984 Inner / 28682 Outer Bearing**
- Fits Dexter 12K Axles, Hi or Lo-Profile
- Capacity of 6,000 lbs. per each
- Drum Size: 12 1/4" x 5"
- Drum Available with ABS exciter ring installed
- 4.75" Hub Pilot

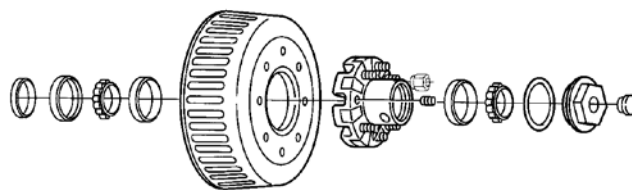

AXLE  
COMPONENTS

PART NO.	REF. NO.	DESCRIPTION
8-214-8UC1	113000	COMPLETE HUB ASSEMBLY (16" & 16.5" DIAMETER WHEELS)
8-214-8	112800	HUB ONLY (16" & 16.5" DIAMETER WHEELS)
8-216-5UC1	112600	COMPLETE HUB ASSEMBLY (14.5" DIAMETER WHEELS)
8-216-5	112400	HUB ONLY (14.5" DIAMETER WHEELS)
9-28-1	124600	BRAKE DRUM ONLY, NON-ABS
9-28-5	124605	BRAKE DRUM ONLY, W/ ABS EXCITER RING
7-244	150600	DRUM MOUNTING BOLT
3984	131800	INNER BEARING
28682	132000	OUTER BEARING
3920	138000	INNER RACE
28622	137800	OUTER RACE
10-56	162000	UNITIZED OIL SEAL, (4.50" O.D., 3.125" I.D.)
RG04-270	150955	OIL CAP KIT (21-36 CAP, 10-50 O-RING, 46-32 PLUG)
7-115	145600	DRIVE-IN STUD, 5/8" DIAMETER
33-52-1	142800	WHEEL RETAINING RING
6-109	141000	5/8" CONE WHEEL NUT



## 8 Bolt, 6.5" Bolt Circle

- **Oil Bath Hub, 3984 Inner / 28682 Outer Bearing**
- Fits Dexter 12K Disc Brake, Hi-Profile Axles (16" & 16.5" diameter wheels)
- Capacity of 6,000 lbs. per each
- Rotor available with ABS exciter ring installed
- 4.75" Hub Pilot

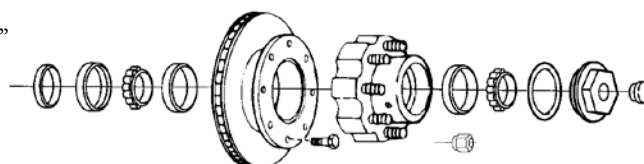

PART NO.	REF. NO.	DESCRIPTION
8-214-10UC1	113020	COMPLETE HUB ASSEMBLY (ROTOR NOT INCLUDED)
8-214-10	113010	HUB ONLY
70-006	124950	BRAKE ROTOR ONLY, NON-ABS
70-006-2	124955	BRAKE ROTOR ONLY, W/ ABS EXCITER RING
6-46	193000	ROTOR MOUNTING NUT
3984	131800	INNER BEARING
28682	132000	OUTER BEARING
3920	138000	INNER RACE
28622	137800	OUTER RACE
10-56	162000	UNITIZED OIL SEAL, (4.50" O.D., 3.125" I.D.)
RG04-270	150955	OIL CAP KIT (21-36 CAP, 10-50 O-RING, 46-32 PLUG)
46-52	156000	OIL HUB PLUG
7-115	145600	DRIVE-IN STUD, 5/8" DIAMETER
33-52-1	142800	WHEEL RETAINING RING
6-109	141000	5/8" CONE WHEEL NUT



## 8 Bolt, 275mm Bolt Circle (Dual Wheel)

AXLE  
COMPONENTS

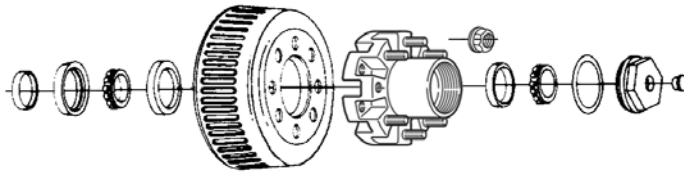

- Oil Bath Hub, 3984 Inner / 28682 Outer Bearing
- Fits Dexter 15K Axles, RH & LH Side
- Capacity of 7,500 lbs. per each
- Drum Size: 12 1/4" x 5"
- Drum available with ABS exciter ring installed
- Std stud length, for use w/steel wheels
- Long stud length (Aluminum Wheels) Available



PART NO.	REF. NO.	DESCRIPTION
8-401-5UC1	113075	COMPLETE HUB ASSEMBLY (BRAKE DRUM NOT INCLUDED)
8-401-5	113050	HUB ONLY
9-28-1	124600	BRAKE DRUM ONLY, NON-ABS
9-28-5	124605	BRAKE DRUM ONLY, W/ ABS EXCITER RING
7-244	150600	DRUM MOUNTING BOLT
3984	131800	INNER BEARING
28682	132000	OUTER BEARING
3920	138000	INNER RACE
28622	137800	OUTER RACE
10-56	162000	UNITIZED OIL SEAL, (4.50" O.D., 3.125" I.D.)
RG04-270	150955	OIL CAP KIT (21-36 CAP, 10-50 O-RING, 46-32 PLUG)
7-194	145325	DRIVE-IN STUD, STD LENGTH, 22MM X 1.5, 3.94" LONG
6-118	141700	WHEEL NUT, SWIVEL-FLANGE, 22MM, 1-5/16" OD HEX

## 10 Bolt, 8.75" Bolt Circle (Dual Wheel)

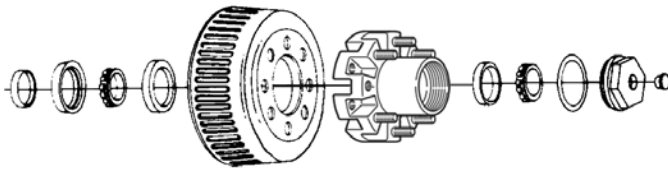

- Oil Bath Hub, 3984 Inner / 28682 Outer Bearing
- Fits Dexter 15K Axles (old style)
- Capacity of 7,500 lbs. per each
- Drum Size: 12 1/4" x 5"
- Drum available with ABS exciter ring installed
- Replacement Hubs no longer available



PART NO.	REF. NO.	DESCRIPTION
9-28-1	124600	BRAKE DRUM ONLY, NON-ABS
9-28-5	124605	BRAKE DRUM ONLY, W/ ABS EXCITER RING
7-244	150600	DRUM MOUNTING BOLT
3984	131800	INNER BEARING
28682	132000	OUTER BEARING
3920	138000	INNER RACE
28622	137800	OUTER RACE
10-56	162000	UNITIZED OIL SEAL, (4.50" O.D., 3.125" I.D.)
RG04-270	150955	OIL CAP KIT, (21-36 CAP, 10-50 O-RING, 46-32 PLUG)
25-13-1	149000	SCREW-IN STUD, RH
25-13-2	149200	SCREW-IN STUD, LH
6-69-1	142000	1 3/16" RH INNER WHEEL NUT
6-69-2	142200	1 3/16" LH INNER WHEEL NUT
6-70-1	142400	1 1/2" RH OUTER WHEEL NUT
6-70-2	142600	1 1/2" LH OUTER WHEEL NUT

## NEV-R-LUBE®

**No need to pull the hubs to repack the bearings!**  
**No need to replace seals when you check the brakes!**  
**No more inner and outer bearings!**

AXLE  
COMPONENTS

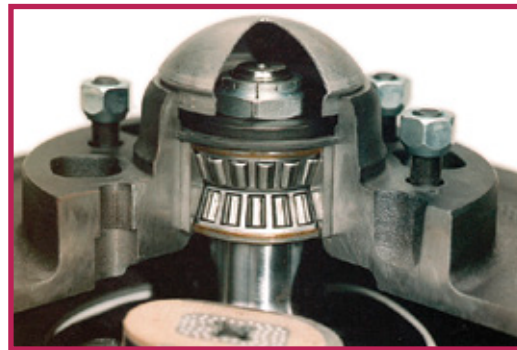

### Pre-set Adjustments.

Ease of installation. Human error is virtually eliminated in bearing adjustment.

### Pre-Lubricated at the Bearing Factory.

Resistant to contamination.

### Sealed for Life.

No bearing maintenance. Increased durability and reliability.

### Lower maintenance cost.

5-year or 100,000 mile warranty against defects in material or workmanship.

Available in 35mm cartridge, 42mm cartridge and 50mm cartridge.

## NEV-R-LUBE® 6 Bolt, 5.5" Bolt Circle

- Fits Dexter 35MM NEV-R-LUBE® Axle
- Capacity of 1,750 lbs. per each
- Drum size: 10" x 2 1/4"
- Discontinued Axle Option by Dexter, effective February 1, 2011.

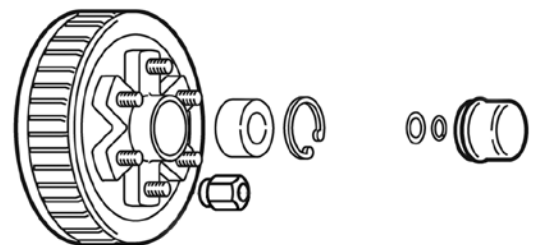

PART NO.	REF. NO.	DESCRIPTION
8-386-80UC3	118276	COMPLETE HUB & DRUM ASSEMBLY
8-386-80	118251	HUB & DRUM W/BEARING & RETAINER
31-72-3	130885	CARTRIDGE BEARING, 35MM X 64M X 37MM
69-94	167845	SNAP RING, INNER BEARING RETAINER, 2.51" O.D.
69-96	167875	SNAP RING, OUTER RETAINER, .821" O.D.
21-39	155300	GREASE CAP, 2.75" O.D., DRIVE-IN
X1023R	140600	1/2" CONE WHEEL
92-2	167900	TORQUE INFORMATION DISC



## NEV-R-LUBE® 6 Bolt, 5.5" Bolt Circle

AXLE  
COMPONENTS

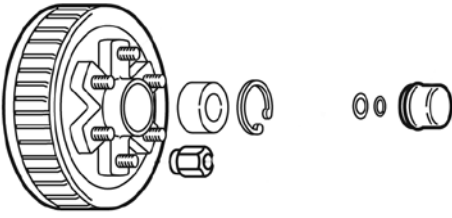

- Fits Dexter 42MM NEV-R-LUBE® Axle
- Capacity of 3,000 lbs. per each
- Drum size: 12"x2"

PART NO.	REF. NO.	DESCRIPTION
8-388-80UC3	119526	COMPLETE HUB & DRUM ASSEMBLY
8-388-80	119501	HUB & DRUM W/BEARING & RETAINER
31-73-3	130900	CARTRIDGE BEARING, 42MM X 76MM X 39MM
69-95	167850	SNAP RING, INNER BEARING RETAINER, 3" O.D.
69-96	167875	SNAP RING, OUTER RETAINER, .821" O.D.
1609	152600	GREASE CAP, 3.125" O.D., DRIVE-IN
7-122	144600	DRIVE-IN STUD, 1/2" DIA. X 1.99" LONG
165995	145000	DRIVE-IN STUD, 1/2" DIA X 2.50" LONG
7-262	145001	DRIVE-IN STUD, 1/2" DIA X 2.70" LONG
X1023R	140600	1/2" CONE WHEEL NUT
92-2	167900	TORQUE INFORMATION DISC

## NEV-R-LUBE® 8 Bolt, 6.5" Bolt Circle

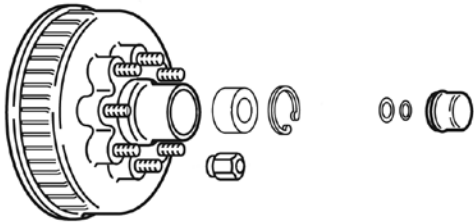

- Fits Dexter 50MM NEV-R-LUBE® Axle
- Capacity of 3,500 lbs. per each
- Drum size: 12"x2"
- 1/2" Stud Size (9/16" & 5/8" Available)

PART NO.	REF. NO.	DESCRIPTION
8-385-82UC3	119576	COMPLETE HUB & DRUM ASSEMBLY
8-385-82	119551	HUB & DRUM W/BEARING & RETAINER
31-71-3	130875	CARTRIDGE BEARING, 50MM X 84MM X 54MM
69-93	167840	SNAP RING, INNER BEARING RETAINER, 3.35" O.D.
69-96	167875	SNAP RING, OUTER RETAINER, .821" O.D.
75DC	153000	GREASE CAP, 3.355" O.D., DRIVE-IN
7-122	144600	DRIVE-IN STUD, 1/2" DIA. X 1.99" LONG
165995	145000	DRIVE-IN STUD, 1/2" DIA X 2.50" LONG
7-262	145001	DRIVE-IN STUD, 1/2" DIA X 2.70" LONG
X1023R	140600	1/2" CONE WHEEL
92-2	167900	TORQUE INFORMATION DISC

## NEV-R-LUBE® 8 Bolt, 6.5" Bolt Circle

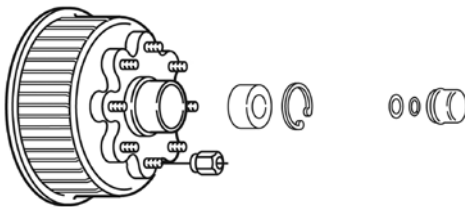

- Fits Dexter 50MM NEV-R-LUBE® Axle
- Capacity of 4,000 lbs. per each
- Drum size: 12 1/4" x 3 3/8"
- 9/16" Stud Size (5/8" Available)

PART NO.	REF. NO.	DESCRIPTION
8-389-81UC3	123178	COMPLETE HUB & DRUM ASSEMBLY
8-389-81	123176	HUB & DRUM W/BEARING & RETAINER
31-71-3	130875	CARTRIDGE BEARING, 50MM X 84MM X 54MM
69-93	167840	SNAP RING, INNER BEARING RETAINER, 3.35" O.D.
69-96	167875	SNAP RING, OUTER RETAINER, .821" O.D.
75DC	153000	GREASE CAP, 3.355" O.D., DRIVE-IN
7-132	145200	DRIVE-IN STUD, 9/16" DIAMETER
6-53	140800	9/16" CONE WHEEL NUT
92-2	167900	TORQUE INFORMATION DISC

## Disc Brake: 5 Bolt, 4.5" Bolt Circle



- **L68149 Inner / L44649 Outer Bearings**
- Fits #84 Spindle (Most 3,500 lb. axles)
- Disc Brake Conversion Kits & Service Parts
- Std. Grease & Grease Lube Applications
- Economical One-Piece Hub/Rotor Design or Slip-On Rotor Design
- Available in Machine or Dacromet Finish (Marine)
- Stainless Steel also available



AXLE  
COMPONENTS

PART NO.	REF. NO.	DESCRIPTION
2/HRCM-10KIT*	193125	3.5K 545 HUB/ROTOR DISC KIT, 1 AXLE (MACHINE FINISH)
2/HRCM-10-DAC-KIT*	193127	3.5K 545 HUB/ROTOR DISC KIT, 1 AXLE (DACROMET FINISH)
2/HRCM-10-DAC-SS-KIT*	193128	3.5K 545 HUB/ROTOR DISC KIT, 1 AXLE (DACROMET FINISH, DAC ROTOR, SS CALIPER)
2/RCM-10-DAC-KIT	193129	10" DACROMET ROTOR KIT, 545 W/CALIPERS & BKTS (1 AXLE)
2/RCM-10-DAC-SS-KIT	193131	10" DACROMET ROTOR KIT, 545 W/SS CALIPERS, DACROMET BKTS (1 AXLE)
ROTOR-10-DAC	193156	10" ROTOR ONLY, 3.5K 545 (DACROMET)
ROTOR/HUB-10	193157	10" INTEGRAL HUB/ROTOR ONLY, 3.5K 545 (MACHINE)
ROTOR/HUB-10-DAC	193158	10" INTEGRAL HUB/ROTOR ONLY, 3.5K 545 (DACROMET)
2/DBC-225-E	193187	CALIPER SET W/PADS FOR 10" & 12" ROTOR (1 PAIR) (E-COAT)
DBC-225-DAC	193194	CALIPER SET W/PADS FOR 10" & 12", 1 WHL (DACROMET)
2/CMB-10-I	193220	CALIPER BKTS, 1 PAIR, FOR 3.5K, 10" HUB/ROTOR (E-COAT)
DBC-225-CERM-PAD	193197	DISC BRAKE PAD KIT, (CERAMIC) FITS DEX 3.5K & KODIAK (ONE AXLE)
L68149	129200	INNER BEARING
L44649	129000	OUTER BEARING
L68111	135000	INNER RACE
L44610	134400	OUTER RACE
58846	158800	GREASE SEAL (2.565" O.D., 1.719" I.D.), SINGLE LIP
10-19	159000	GREASE SEAL (2.565" O.D., 1.719" I.D.), FOR GRS LUBE, DOUBLE LIP
46749	151200	GREASE CAP, 1.986" O.D., DRIVE-IN
21-41-1	151400	GREASE CAP, 1.986" O.D., DRIVE-IN, FOR GRS LUBE
85-1	155400	GREASE CAP PLUG FOR GRS LUBE
LB169	144425	DRIVE-IN STUD, 1/2" DIA., 1.69" LONG
X1023R	140600	1/2" CONE WHEEL NUT

\* Disc Kit includes 2ea. Integral Hub/Rotors, 1 pair Calipers w/pads & Brackets for one axle. (Inner/Outer Bearings, Grease Seals, Caps & Wheel Nuts sold separately).

## Disc Brake: 5 Bolt, 4.5" Bolt Circle

- **L68149 Inner / L44649 Outer Bearings**
- Fits Dexter and most other 3,500 lb. axles
- Complete Disc Conversion Kits & Components
- Std. Grease & E-Z LUBE® Applications
- Two-Piece Hub/Rotor Design

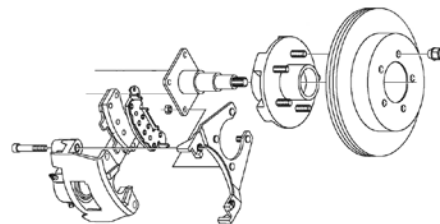

PART NO.	REF. NO.	DESCRIPTION
K71-633*	193134	DEX 3.5K DISC BRAKE CONVERSION KIT LH
K71-634*	193135	DEX 3.5K DISC BRAKE CONVERSION KIT RH
K71-623	193212	DISC BRAKE PAD KIT, DEX 3.5K (ONE AXLE)
K71-624	193208	LH CALIPER W/PADS, DEX 3.5K (1 WHEEL)
K71-625	193209	RH CALIPER W/PADS, DEX 3.5K (1 WHEEL)
K71-626	193188	ROTOR ONLY, DEX 3.5K (FOR 2-PC HUB/ROTOR SYSTEM)
8-248-22	193186	REP'L HUB ONLY, 545 FOR DEXTER 3.5K DISC BRAKE
L68149	129200	INNER BEARING
L44649	129000	OUTER BEARING
L68111	135000	INNER RACE
L44610	134400	OUTER RACE
58846	158800	GREASE SEAL (2.565" O.D., 1.719" I.D.), SINGLE LIP
10-19	159000	GREASE SEAL (2.565" O.D., 1.719" I.D.), FOR E-Z LUBE®, DOUBLE LIP
46749	151200	GREASE CAP, 1.986" O.D., DRIVE-IN
21-41-1	151400	GREASE CAP, 1.986" O.D., DRIVE-IN, FOR E-Z LUBE®
85-1	155400	GREASE CAP PLUG FOR E-Z LUBE®
7-150	144800	DRIVE-IN STUD, 1/2" DIA., 2.24" LONG



\* Disc Kit includes 1ea: 545 Hub, Rotor, Caliper, Bracket, Inner/Outer Bearings, Grease Seal & Cap for one side of axle beam. For complete axle conversion, order 1ea. K71-633 & 1ea. K71-634.



## Disc Brake: 6 Bolt, 5.5" Bolt Circle

- 25580 Inner / 15123 Outer Bearings
- Fits Dexter and most other 5,200 lb./6,000 lb. axles
- Disc Brake Conversion Kits & Service Parts
- Std. Grease & Grease Lube Applications
- Economical One-Piece Hub/Rotor or Slip-On Rotor Design
- Available in Machine or Dacromet Finish (Marine)
- Stainless Steel also available



PART NO.	REF. NO.	DESCRIPTION
2/HRCM-12KIT*	193140	6K 655 HUB/ROTOR DISC KIT, 1 AXLE (MACHINE FINISH)
2/HRCM-12-DAC-KIT*	193142	6K 655 HUB/ROTOR DISC KIT, 1 AXLE, (DACROMET FINISH)
2/HRCM-12-DAC-SS-KIT*	193143	6K 655 HUB/ROTOR DISC KIT, 1 AXLE, (DACROMET FINISH, DAC ROTOR, SS CALIPER)
2/RCM-12-DAC-KIT	193144	12" DACROMET ROTOR KIT, 655 W/CALIPERS & BKTS (1 AXLE)
2/RCM-12-DAC-SS-KIT	193145	12" DACROMET ROTOR KIT, 655 W/SS CALIPERS & DACROMET BKTS (1 AXLE)
ROTOR/HUB-12	193162	12" INTEGRAL HUB/ROTOR ONLY, 6K 655 (MACHINE)
ROTOR/HUB-12-DAC	193164	12" INTEGRAL HUB/ROTOR ONLY, 6K 655 (DACROMET)
ROTOR-12-DAC	193161	12" ROTOR ONLY, 655 6K (DACROMET)
2/DBC-225-E	193187	CALIPER SET W/PADS FOR 10" & 12" ROTOR (1 PAIR) (E-COAT)
DBC-225-DAC	193194	CALIPER W/PADS (DACROMET) 1 WHEEL
2/CMB-12-UA	193225	CALIPER BKTS, 1 PAIR, FOR 6K, 12" HUB/ROTOR (E-COAT)
DBC-225-CERM-PAD	193197	DISC BRAKE PAD KIT, (CERAMIC) KODIAK (ONE AXLE)
25580	130800	INNER BEARING
15123	130400	OUTER BEARING
25520	136200	INNER RACE
15245	135600	OUTER RACE
42385	159600	GREASE SEAL (3.375" O.D., 2.25" I.D.), SINGLE LIP
10-36	159700	GREASE SEAL (3.375" O.D., 2.25" I.D.), FOR GRS LUBE, DOUBLE LIP
45896	151600	GREASE CAP, 2.44" O.D., DRIVE-IN
21-42-1	151800	GREASE CAP, 2.44" O.D., DRIVE-IN, FOR GRS LUBE
85-1	155400	GREASE CAP PLUG FOR GRS LUBE
LB2.0	144775	DRIVE-IN STUD, 1/2" DIA., 2.00" LONG
X1023R	140600	1/2" CONE WHEEL NUT

\* Disc Kit includes 2ea. Integral Hub/Rotors, 1 pair Calipers w/Pads & Brackets for one axle. (Inner/Outer Bearings, Grease Seals, Caps & Wheel Nuts sold separately).

## Disc Brake: 6 Bolt, 5.5" Bolt Circle

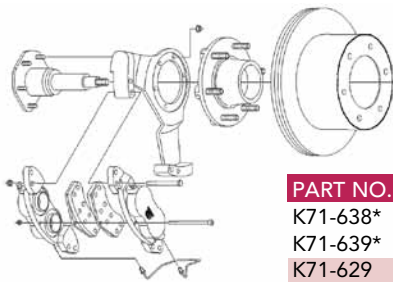

- 25580 Inner / 15123 Outer Bearings & NEV-R-LUBE®
- Fits Dexter and most other 5,200lb/6,000lb axles
- Complete Disc Conversion Kits & Components
- Std. Grease, E-Z LUBE® & NEV-R-LUBE® Applications
- Two-Piece Hub/Rotor Design

PART NO.	REF. NO.	DESCRIPTION
K71-638*	193136	DEX 6K DISC BRAKE CONVERSION KIT LH
K71-639*	193137	DEX 6K DISC BRAKE CONVERSION KIT RH
K71-629	193217	REP'L DISC PAD KIT, DEX 6K-8K (ONE AXLE)
K71-636	193213	REP'L CALIPER, W/CALIPER BOLTS (1 WHEEL)
K71-637	193193	REP'L DISC ROTOR, DEX 6K
8-403-5	193191	REP'L HUB ONLY, 655 FOR DEXTER 6K DISC BRAKE
8-404-80	193192	DEXTER 6K DISC NEV-R-LUBE® HUB W/42MM BEARING & RETAINER
31-73-3	130900	NEV-R-LUBE® CARTRIDGE BEARING, 42MM X 76MM X 39MM
25580	130800	INNER BEARING
15123	130400	OUTER BEARING
25520	136200	INNER RACE
15245	135600	OUTER RACE
42385	159600	GREASE SEAL (3.375" O.D., 2.25" I.D.), SINGLE LIP
10-36	159700	GREASE SEAL (3.375" O.D., 2.25" I.D.), FOR E-Z LUBE®, DOUBLE LIP
1609	152600	GREASE CAP, 3.125" O.D., DRIVE-IN FOR NEV-R-LUBE®
45896	151600	GREASE CAP, 2.44" O.D., DRIVE-IN
21-42-1	151800	GREASE CAP, 2.44" O.D., DRIVE-IN, FOR E-Z LUBE®
85-1	155400	GREASE CAP PLUG FOR E-Z LUBE®
7-150	144800	DRIVE-IN STUD, 1/2" DIA., 2.24" LONG
X1023R	140600	1/2" CONE WHEEL NUT



\* Disc Kit includes 1ea 655 Hub, Rotor, Caliper, Disc Pads, Bracket, Inner/Outer Bearings, Grease Seal & Cap for one side of axle beam. For complete axle conversion, order 1ea. K71-638 & 1ea. K71-639.

## Disc Brake: 8 Bolt, 6.5" Bolt Circle



- 25580 Inner / 14125A Outer Bearings
- Fits Dexter and most other 5,200lb/6,000lb/7,000lb axles
- Disc Brake Conversion Kits & Service Parts
- Std. Grease & Grease Lube Applications
- Economical One-Piece Hub/Rotor Design
- 1/2" Stud Diameter
- Machine Finish or S-Cad Coating (Marine)



AXLE  
COMPONENTS

PART NO.	*REF. NO.	DESCRIPTION
2/HRCM-133-7-8-KIT*	193146	7K 865 INTEGRAL (1-PIECE) HUB/ROTOR DISC KIT, 1 AXLE (MACHINE)
2/HRCM-133-7-8-SCAD-KIT	193147	7K 865 INTEGRAL (1-PIECE) HUB/ROTOR DISC KIT, 1 AXLE (S-CAD)
ROTOR/HUB-133-7-8	193176	13" INTEGRAL HUB/ROTOR ONLY, 7K 865 KODIAK
2/DBC-250-E	193215	CALIPER SET W/PADS FOR 13" ROTOR (1 PAIR), KODIAK
DBC-250-CERM-PAD	193216	DISC BRAKE PAD SET (CERAMIC) ONE AXLE
2/CMB-133-7	193230	CALIPER BKTS, 1 PAIR, FOR 7K W/INTEGRAL 13" HUB/ROTOR, KODIAK
25580	130800	INNER BEARING
14125A	130600	OUTER BEARING
25520	136200	INNER RACE
14276	135800	OUTER RACE
42385	159600	GREASE SEAL (3.375" O.D., 2.25" I.D.), SINGLE LIP
10-36	159700	GREASE SEAL (3.375" O.D., 2.25" I.D.), FOR GRS LUBE, DOUBLE LIP
38605	152200	GREASE CAP, 2.72" O.D., DRIVE-IN
21-43-1	152400	GREASE CAP, 2.72" O.D., DRIVE-IN, FOR GRS LUBE
85-1	155400	GREASE CAP PLUG FOR GRS LUBE
LB2.0	144775	DRIVE-IN STUD, 1/2" DIA., 2.00" LONG
X1023R	140600	1/2" CONE WHEEL NUT

New  
Marine  
Item!

\* Disc Kit includes 2ea. Integral Hub/Rotors, 1 pair Calipers w/Pads & Brackets for one axle. (Inner/Outer Bearings, Grease/Oil Seals & Wheel Nuts sold separately).

## Disc Brake: 8 Bolt, 6.5" Bolt Circle



DEXTER AXLE

PART NO.	REF. NO.	DESCRIPTION
K71-693-00	193214	REP'L CALIPER, W/CALIPER BOLTS (1 WHEEL)
K71-629-00	193217	REP'L DISC PAD KIT, DEX 6K, 7K, 8K (1 AXLE)
K71-694-00	193198	DEX 7K DISC KIT, LH, (CALIPER, PADS, BKT & HDWE) LESS ROTOR
K71-695-00	193199	DEX 7K DISC KIT, RH, (CALIPER, PADS, BKT & HDWE) LESS ROTOR
008-416-90*	193165	DEX 7K HUB/ROTOR KIT, 865, 1/2" STUD, GREASE
008-416-92*	193166	DEX 7K HUB/ROTOR KIT, 865, 9/16" STUD, GREASE
008-416-96*	193167	DEX 7K HUB/ROTOR KIT, 865, 1/2" STUD, E-Z LUBE®
008-416-97*	193168	DEX 7K HUB/ROTOR KIT, 865, 9/16" STUD, E-Z LUBE®
25580	130800	INNER BEARING
14125A	130600	OUTER BEARING
25520	136200	INNER RACE
14276	135800	OUTER RACE
42385	159600	GREASE SEAL (3.375" O.O., 2.25" I.D.), SINGLE LIP
10-36	159700	GREASE SEAL (3.375" O.O., 2.25" I.D.), FOR E-Z LUBE®, DOUBLE LIP
38605	152200	GREASE CAP, 2.72" O.D., DRIVE-IN
21-43-1	152400	GREASE CAP, 2.72" O.D., DRIVE-IN, FOR E-Z LUBE®
85-1	155400	GREASE CAP PLUG FOR E-Z LUBE®
7-122	144600	DRIVE-IN STUD, 1/2" DIAMETER
7-223	145300	DRIVE-IN STUD, 9/16 DIAMETER
X1023R	140600	1/2" CONE WHEEL NUT
6-53	140800	9/16" CONE WHEEL NUT

- 25580 Inner / 14125A Outer Bearings
- Fits Dexter 7,000lb axles
- Complete Conversion Kits & Components
- Std. Grease & E-Z LUBE® Applications (Oil Bath by special order)
- Std. 1/2" or 9/16" Wheel Studs (5/8" by special order)
- One-Piece Hub/Rotor Design

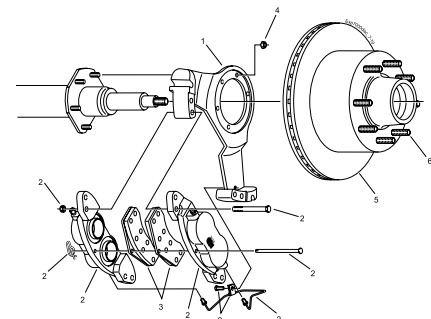

\* Hub/Rotor Kit includes: Hub/Rotor, 14125A outer/25580 inner bearings, 2.25" Grease Seal, Dust Cap & Wheel Nuts

## Disc Brake: 8 Bolt, 6.5" Bolt Circle



- 25580 Inner / 02475 Outer Bearings
- Fits Dexter 8,000 lb. axles
- Disc Brake Conversion Kits & Service Parts
- Oil Bath or Greased Bearing Lubrication
- Economical One-Piece Hub/Rotor Design
- 9/16" or 5/8" Studs



PART NO.	REF. NO.	DESCRIPTION
2/HRCM-133-8-9KIT*	193150	8K 865 INTEGRAL DISC KIT, 9/16" STUDS, 1 AXLE, KODIAK
2/HRCM-133-8-10KIT*	193155	8K 865 INTEGRAL DISC KIT, 5/8" STUDS, 1 AXLE, KODIAK
ROTOR/HUB-133-8-9**	193200	13" INTEGRAL HUB/ROTOR ONLY, 8K 865 9/16" STUDS, KODIAK
ROTOR/HUB-133-8-10**	193205	13" INTEGRAL HUB/ROTOR ONLY, 8K 865 5/8" STUDS, KODIAK
2/DBC-250-E	193215	CALIPER SET W/PADS FOR 13" ROTOR (1 PAIR), KODIAK
2/CMB-133-8DI	193235	CALIPER BKTS, 1 PAIR, FOR 8K W/INTEGRAL 13" HUB/ROTOR, KODIAK
25580	130800	INNER BEARING
02475	131000	OUTER BEARING
25520	136200	INNER RACE
02420	137000	OUTER RACE
10-63	161225	UNITIZED OIL SEAL (3.376" O.D., 2.25" I.D.)
10-36	159700	GREASE SEAL (3.375" O.D., 2.25" I.D.), FOR GRS LUBE, DOUBLE LIP
RG04-230	150940	OIL CAP KIT (21-35 CAP, 10-45 O-RING, 46-32 PLUG)
7-115	145600	DRIVE-IN STUD, 5/8" DIA., 3.16" LONG
6-53	140800	9/16" CONE WHEEL NUT
6-109	141000	5/8" CONE WHEEL NUT
95188	141600	5/8" FLANGE WHEEL NUT

\* Disc Kit includes 2ea. Integral Hub/Rotors, 1 pair Calipers w/Pads & Brackets for one axle.  
 \*\* Hub/Rotors come w/21-35 Oil Cap, and are suitable for Oil Bath OR Greased Bearing Lubrication.  
 (Inner/Outer Bearings, Grease/Oil Seals & Wheel Nuts sold separately).



## Disc Brake: 8 Bolt, 6.5" Bolt Circle

### DEXTER AXLE

- 25580 Inner / 02475 Outer Bearings & NEV-R-LUBE®
- Fits Dexter 8,000 lb. axles
- Complete Disc Conversion Kits & Components
- Oil Bath, E-Z LUBE® & NEV-R-LUBE® Applications
- Two-Piece Hub/Rotor Design
- 9/16" or 5/8" Studs

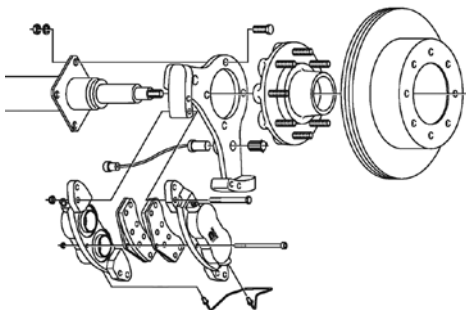

PART NO.	REF. NO.	DESCRIPTION
K71-635*	193160	DEXTER 8K DISC KIT, 1 WHEEL, LESS HUB
8-399-90**	193165	DEXTER 8K DISC HUB KIT 9/16" STUD, E-Z LUBE®
8-399-91**	193170	DEXTER 8K DISC HUB KIT 9/16" STUD, OIL BATH
8-399-92**	193175	DEXTER 8K DISC HUB KIT 5/8" STUD, E-Z LUBE®
8-399-93**	193180	DEXTER 8K DISC HUB KIT 5/8" STUD, OIL BATH
8-402-80	193182	DEXTER 8K DISC NEV-R-LUBE® HUB W/BEARING & RETAINER, 9/16" STUD
8-402-81	193183	DEXTER 8K DISC NEV-R-LUBE® HUB W/BEARING & RETAINER, 5/8" STUD
K71-630	193218	REP'L CALIPER, W/CALIPER BOLTS (1 WHEEL) 8K
K71-631	193206	REP'L DISC ROTOR, DEX 8K
K71-629	193217	REP'L DISC PAD KIT, DEX 6K-8K (ONE AXLE)
31-71-3	130875	NEV-R-LUBE® CARTRIDGE BEARING, 50MM X 84MM X 54MM
25580	130800	INNER BEARING
02475	131000	OUTER BEARING
25520	136200	INNER RACE
02420	137000	OUTER RACE
10-63	161225	UNITIZED OIL SEAL (3.376" O.D., 2.25" I.D.)
10-36	159700	GREASE SEAL (3.376" O.D., 2.25" I.D.), FOR E-Z LUBE®, DOUBLE LIP
21-43-1	152400	GREASE CAP, 2.72" O.D., DRIVE-IN, FOR E-Z LUBE®
85-1	155400	GREASE CAP PLUG FOR E-Z LUBE®
RG04-230	150940	OIL CAP KIT (21-35 CAP, 10-45 O-RING, 46-32 PLUG)
7-257	145310	DRIVE-IN STUD, 9/16" DIA., 2.50" LONG
7-115	145600	DRIVE-IN STUD, 5/8" DIA., 3.16" LONG
6-53	140800	9/16" CONE WHEEL NUT
6-109	141000	5/8" CONE WHEEL NUT
95188	141600	5/8" FLANGE WHEEL NUT

\* Disc Kit includes 1ea. 8K Rotor, Caliper, Disc Pads, Bracket, & Hardware for Standard Grease or E-Z LUBE® Axle Conversions to one side of axle beam.  
 \*\* Disc Hub Kits include Inner/Outer Bearing, Seal & Dust Cap.

## Grease Seals, Oil Seals and Wear Sleeves

PART NO.	REF. NO.	DESCRIPTION	I.D.	O.D.	USE WITH:
34823	157800	SINGLE LIP SEAL	1.249	1.983	BT8 SPINDLES
12192TB	157805	DOUBLE LIP SEAL	1.250	1.979	BT8 SPINDLES
13194	157810	SINGLE LIP SEAL	1.372	1.983	UNIQUE BT HUBS
10-9	158000	SINGLE LIP SEAL	1.500	1.987	BTR SPINDLES
10-60	158200	DOUBLE LIP SEAL	1.500	1.987	E-Z LUBE@ 2,000 LB
1105-100-031	158400	DOUBLE LIP SEAL	1.750	2.356	10" HADCO
10-42	158600	SINGLE LIP SEAL	1.750	2.312	DEX 2,800 LB AXLES
168233	158750	DOUBLE LIP SEAL	1.688	2.332	UNIQUE #84 HUBS
168255TB	158755	DOUBLE LIP SEAL	1.687	2.561	MARINE HUBS
10-40	158775	SINGLE LIP SEAL	1.938	2.510	MHU AXLES
58846	158800	SINGLE LIP SEAL	1.719	2.565	3,500 LB AXLES
10-19	159000	DOUBLE LIP SEAL	1.719	2.565	E-Z LUBE@ 3,500 LB
29031	159200	SINGLE LIP SEAL	1.875	3.000	#8 SPINDLE
1105-100-035	159400	SINGLE LIP SEAL	2.000	2.875	12" HADCO
21325	159500	SINGLE LIP SEAL	2.125	3.269	UNIQUE #42 HUBS
42385	159600	SINGLE LIP SEAL	2.250	3.376	5.2K - 7K AXLES
10-36	159700	DOUBLE LIP SEAL	2.250	3.376	E-Z LUBE@ 5.2K - 7K AXLES
10-1	159800	SINGLE LIP SEAL	2.125	3.375	5.2K - 7K AXLES
10-10	160000	DOUBLE LIP SEAL	2.125	3.376	E-Z LUBE@ 5.2K - 7K AXLES
T51153	160200	SINGLE LIP SEAL	2.375	3.623	#99 SPINDLE
SL150	160400	SINGLE LIP SEAL	1.500	2.332	AGRICULTURAL HUB
SL175	160600	SINGLE LIP SEAL	1.750	2.722	AGRICULTURAL HUB
SL200	160800	SINGLE LIP SEAL	2.000	3.066	AGRICULTURAL HUB
SL226	161000	SINGLE LIP SEAL	2.250	3.066	AGRICULTURAL HUB
SL275	161200	SINGLE LIP SEAL	2.750	3.756	AGRICULTURAL HUB
10-63	161225	UNITIZED OIL SEAL	2.250	3.376	DEX 8K (& 9K, 'TIL 10/89)
9103309	161227	DOUBLE LIP, DOUBLE CASE	2.250	3.376	8K HAYES
10-48	161230	OIL SEAL	2.375	3.376	OLD STYLE 8K
10-51	161650	UNITIZED OIL SEAL	2.875	3.880	DEX 9K, 10K GD
10-56	162000	UNITIZED OIL SEAL	3.125	4.500	DEX 10K, 12K, 15K & HAYES
382-8005	162410	OIL SEAL W/SLEEVE	2.775	3.671	INCLUDES 2.671 I.D. WEAR SLEEVE
10-55-1	162800	UNITIZED OIL SEAL	4.625	6.000	20K - 25K AXLES
91030	163000	UNITIZED OIL SEAL	2.750	3.779	HAYES #99 SPINDLE

AXLE COMPONENTS



### Grease Seals



Packaged double lip seals provide extra protection and longer life than standard single lip seals. Two per package.

PART NO.	REF. NO.	SEAL	I.D.	O.D.	INTERCHANGE#
RG06-010	157700	12192TB	1.250"	1.979"	34823
RG06-020	157710	10-60	1.500"	1.987"	10-9
RG06-050	157720	10-19	1.719"	2.565"	58846
RG06-070	157730	10-36	2.250"	3.376"	42385
RG06-090	157740	10-10	2.125"	3.376"	10-1



## Grease Caps & Cap Plugs

AXLE  
COMPONENTS



PART NO.	REF. NO.	DESCRIPTION	O.D.
1527	151000	DRIVE-IN, AG HUBS	1.957
46749	151200	DRIVE-IN, 2K & 3.5K AXLES	1.986
21-3-1	151400	DRIVE-IN, E-Z LUBE® 2K & 3.5K AXLES	1.986
45896	151600	DRIVE-IN, 5.2K AXLES W/ 6 BOLT HUBS	2.440
21-1-1	151800	DRIVE-IN, E-Z LUBE® 5.2K & 6K AXLES W/ 6 BOLT HUBS	2.440
1604	152000	DRIVE-IN, AG HUBS	2.440
38605	152200	DRIVE-IN, 5.2K, 6K & 7K AXLES, OLD STYLE "DOME CAP"	2.720
21-39	152300	DRIVE-IN, 5.2K, 6K & 7K AXLES, NEW STYLE & 35MM NEV-R-LUBE®	2.720
21-43-1	152400	DRIVE-IN, E-Z LUBE® 5.2K, 6K & 7K, 8 BOLT AXLES	2.720
1609	152600	DRIVE-IN, AG HUBS & 42MM NEV-R-LUBE®	3.125
1602	152800	DRIVE-IN, VILLAGE 7K AXLES	3.250
75DC	153000	DRIVE-IN, #99 SPINDLES & 50MM NEV-R-LUBE®	3.355
092105	153200	DRIVE-IN, HAYES 10K & 12K AXLES	3.625
85-1	155400	GREASE CAP PLUG, ALL E-Z LUBE® CAPS	N/A

## Packaged Grease Caps



Protect bearings from contamination with packaged grease caps. Two caps per package.

PART NO.	REF. NO.	DESCRIPTION
RG04-010	150900	PLUG ONLY FOR E-Z LUBE® GREASE CAPS
RG04-020	150905	1.986" O.D., DRIVE-IN
RG04-040	150910	1.986" O.D., DRIVE-IN W/ PLUG FOR E-Z LUBE®
RG04-060	150915	2.44" O.D., DRIVE-IN
RG04-080	150920	2.44" O.D., DRIVE-IN W/ PLUG FOR E-Z LUBE®
RG04-100	150925	2.72" DRIVE-IN
RG04-120	150930	2.72" DRIVE-IN W/ PLUG FOR E-Z LUBE®

## Cap Driver Tools



Custom-sized specifically for trailer axle dust caps, this dust cap driver can be used for installation, removal, and servicing trailer hubs without denting the dust caps. Designed for ease of use by dust cap installers, no professional trailer service center will want to be without this handy tool.

PART NO.	REF. NO.	DESCRIPTION
290-991	151425	DUST CAP DRIVER/TOOL, (SM) FITS 46749, 21-3-1
290-992	151825	DUST CAP DRIVER/TOOL, (MED) FITS 45896, 21-1-1
290-993	152425	DUST CAP DRIVER/TOOL, (LG) FITS 21-39, 21-43-1

## Bearing Protectors



RG07-045

RG07-040



11073



Bearing Protectors keep grease inside the hub and water out! An overload outlet allows grease to escape if the hub is overfilled or excessive pressure is built up. Fits 1.980" 2K-3.5K hubs with L44610 outer race. Bearing Protector Covers keep the excess grease from being thrown on the wheels while trailering.

PART NO.	REF. NO.	DESCRIPTION
BLB1	414000	BEARING PROTECTOR COVER, FITS 2.125" O.D., 1EA.
RG07-040	414001	PKGD 1.98" BEARING PROTECTORS & COVERS, 1 PAIR (2" O.D.)
RG07-045	414002	PKGD BRG PROTECTOR COVER, FITS 2" OD PROTECTORS, 1PAIR
11073	414005	1.980" BRG PROTECTOR, STAINLESS STEEL, 2.125" O.D.

## Kodiak RED EYE<sup>®</sup> Bearing Protectors

Protects wheel bearings from contamination by water, salt and dirt by providing and maintaining a positive hub seal. The RED EYE<sup>®</sup> Bearing Protector tells you when it is full and when to add grease; preventing over filling and causing inner-seal failure. When the red washer on the indicator is flat against the housing, it is time to add grease. If the RED EYE<sup>®</sup> indicator repeatedly tells you to add grease, this alerts you of a possible inner-seal failure that you may not realize you have without the RED EYE<sup>®</sup>. Comes in 2 different sizes, with a Limited Lifetime Warranty.



AXLE  
COMPONENTS

With its patented chrome plated aluminum one-piece housing and two O-ring seals, RED EYE<sup>®</sup> is the only bearing protector guaranteed not to leak grease. Most importantly, it assures you it is keeping dirt, water and other contaminants out of the wheel bearing area. This, combined with a spring-loaded piston, maintains a constant positive pressure on the hub, even when submerged in cold lake water.



PART NO.	REF. NO.	DESCRIPTION
REBP1980AC	414003	BRG PROTECTOR, 1 PAIR, 1.980" OD
REBP2440AC	414004	BRG PROTECTOR, 1 PAIR, 2.440" OD

## Bolt-On Oil Caps

PART NO.	REF. NO.	DESCRIPTION
340-4139	157400	OIL CAP, 6 ON 4.06" BOLT, FOR HAYES 10K OLD STYLE
340-4009	157600	OIL CAP, 6 ON 5 1/2" BOLT, FOR 20K - 25K AXLES



340-4009

## Complete Oil Cap Kits

PART NO.	REF. NO.	DESCRIPTION	FITS:
RG04-230	150940	21-35 OIL CAP, 10-45 O-RING 46-32 PLUG	6K, 7K 8K, 9K AXLES (8-BOLT) DEXTER
RG04-250	150945	92125 OIL CAP, 92127 O-RING 9103502 GASKET, 92126 PLUG	10K 12K HAYES / ALKO
RG04-260	150950	21-40 OIL CAP, 10-59 O-RING	6K 7K, OIL BATH HUB & DRUMS (5-SPOKE)
RG04-270	150955	21-36 OIL CAP, 10-50 O-RING, 46-32 PLUG	DEX 9K & 10K GD (THROUGH 07-09) W/2-PC HUB/DRUM
RG04-300	150957	21-88 OIL CAP, 10-163 O-RING, 46-32 PLUG	DEX 9K & 10GD (AFTER 07-09) W/1-PC HUB/DRUM
RG04-280	150960	92128 OIL CAP, 9103501 GASKET, 92126 PLUG	8K HAYES / ALKO (AFTER 01/97)
RG04-290	150965	9212801 OIL CAP, 9103501 GASKET, 92126 PLUG	8K HAYES / ALKO (PRIOR 01/97)



See Pages B-39 thru B-40 for unpackaged items.

## Oil Cap Replacement Parts



PART NO.	REF. NO.	DESCRIPTION	FOR:
21-40	153600	2.563" O.D., SCREW-IN PLASTIC	6K, 7K OIL (5 SPOKE) DX
21-35	153800	2.875" O.D., SCREW-IN PLASTIC	6K-8K (& 9K PRIOR TO 10/89) DX
21-36	153975	4.00" O.D., SCREW-IN PLASTIC	9K (AFTER 10/89) & 10K GD (2-PC DRUM), 10K-15K DX
21-88	153977	4.00" O.D. SCREW-IN PLASTIC	9K & 10K GD (AFTER 07/09) 1-PC DRUM
92128	154100	OIL CAP ONLY	7K-8K AL-KO/HAYES NEW STYLE (AFTER 01/97)
9212801	154150	OIL CAP ONLY	7K-8K HAYES (PRIOR TO 01/97)
92125	154200	3.750" O.D., SCREW-IN	10K, 12K AL-KO/HAYES
46-32	155600	OIL CAP PLUG	21-35, 21-36, 21-37 CAPS
92126	155800	OIL CAP PLUG	92125, 340-4009, 340-4139, 92128
46-52	156000	OIL HUB PLUG	8K-15K DEXTER OIL HUBS
10-45	156600	OIL CAP O-RING	21-35 OIL CAP
10-50	156800	OIL CAP O-RING	21-36 OIL CAP
10-59	156825	OIL CAP O-RING	21-40 OIL CAP
10-163	156830	OIL CAP O-RING	21-88 OIL CAP
92127	157000	OIL CAP O-RING	92125 OIL CAP
9103501	153985	OIL CAP GASKET	92128 & 9212801
9103502	153990	OIL CAP GASKET	92125 (USE W/ 92127 O-RING)

## Replacement Bearings

Replacement Bearings are high quality tapered roller bearings, designed for high-speed use. All bearings have industry standard numbers, regardless of the brand. Inner diameter of bearing is included for your convenience.



PART NO.	REF. NO.	DESCRIPTION	I.D.
L44643	128800	INNER / OUTER FOR BT8	1.000
L44649	129000	INNER / OUTER FOR BTR, OUTER FOR #84 SPINDLES	1.063
L68149	129200	INNER FOR #84 SPINDLES	1.378
1779	129400	OUTER FOR 22834 HUB	0.938
2788	129600	INNER FOR 22834 HUB	1.500
LM48548	129800	INNER FOR AH25555F AGRICULTURAL HUB	1.375
LM67048	130000	OUTER FOR 8-201-5, 8-213-5	1.250
15123	130400	OUTER FOR 42655, 42656, 8-174-5	1.250
14125A	130600	OUTER FOR 42865, 42866, 8-219-4, 8-231-9	1.250
25580	130800	#42, 8K, 9K INNER (PRE 10/89), OUTER FOR #99	1.750
31-71-3	130875	50MM CARTRIDGE STYLE, NEV-R-LUBE®	50MM
31-72-3	130885	35MM CARTRIDGE STYLE, NEV-R-LUBE®	35MM
31-73-3	130900	42MM CARTRIDGE STYLE, NEV-R-LUBE®	42MM
02475	131000	OUTER FOR 8-231-8, 8-218-9, 8-187-7	1.250
2585	131200	OUTER FOR 8-232-5	1.313
387A	131400	OUTER FOR 8-214-5, INNER FOR 8-288-3	2.250
395S	131600	INNER FOR 8-214-5	2.625
3984	131800	INNER FOR 8-216-5, 8-214-8, 8-217-5, 8-272-5	2.625
28682	132000	OUTER FOR 8-216-5, 8-214-8, 8-217-5, 8-727-5	2.250
28580	132200	INNER FOR ALL #99 SPINDLES	2.000
JM205149	132600	FOR 090814 AL-KO/HAYES 10K	1.969
JM511946	132800	FOR 090814 AL-KO/HAYES 10K	2.559
HM212049	133000	OUTER FOR 20K - 25K AXLES	2.625
HM218248	133100	INNER FOR 20K - 25K AXLES	3.542
LM11949	133200	OUTER FOR AH15450E AGRICULTURAL HUB	0.750
LM29749	133600	FOR AH30660F AGRICULTURAL HUB	1.500
LM501349	133800	OUTER FOR AH60080F, INNER FOR AH35660F	1.625
LM506849	134000	FOR AH60880F AGRICULTURAL HUB	2.165
LM603049	134200	FOR AH45880F AGRICULTURAL HUB	1.781

### Makes Bearing Replacements Easier and Quicker! One Kit Per Wheel Required!

#### Wheel Bearing Kits are available for:

- Applications ranging from the BT8 1" spindle to 7,000 lb. spindles
- All kits include: Double Lip Grease Seals, allowing kits to be used with standard or E-Z LUBE® Spindles.

#### Each Wheel Bearing Kit includes:

- One Inner Bearing and Race
- One Outer Bearing and Race
- Grease Seal
- Cotter Pin

PART NO.	REF. NO.	OUTER BEARING	INNER BEARING	SEAL	SEAL I.D.
BK1-100	128611	L44643	L44643	12192TB	1.250"
BK1-150	128621	L44649	L44649	10-60	1.500"
BK2-100	128641	L44649	L68149	10-19	1.719"
BK3-100	128662	15123	25580	10-36	2.250"
BK3-110	128664	15123	25580	10-10	2.125"
BK3-200	128684	14125A	25580	10-36	2.250"
BK3-210	128686	14125A	25580	10-10	2.125"
BK3-300	128704	LM67048	25580	10-36	2.250"
BK3-310	128706	LM67048	25580	10-10	2.125"



### Replacement Races

PART NO.	REF. NO.	DESCRIPTION	O.D.
L44610	134400	FOR L44643, L44649 BEARING	1.980
1729	134600	FOR 1779 BEARING	2.240
2729	134800	FOR 2788 BEARING	3.000
L68111	135000	FOR L68149 BEARING	2.361
LM48510	135200	FOR LM48548 BEARING	2.563
LM67010	135400	FOR LM67048 BEARING	2.328
15245	135600	FOR 15123 BEARING	2.441
14276	135800	FOR 14125A BEARING	2.717
25520	136200	FOR 25580 BEARING	3.265
28521	136800	FOR 28580 BEARING	3.625
02420	137000	FOR 02475 BEARING	2.688
2520	137200	FOR 2585 BEARING	2.615
382A	137400	FOR 387A BEARING	3.813
394A	137600	FOR 395S BEARING	4.331
28622	137800	FOR 28682 BEARING	3.844
3920	138000	FOR 3984 BEARING	4.438
JM205110	138200	FOR JM205149 BEARING	3.543
JM511910	138400	FOR JM511946 BEARING	4.331
LM11910	139000	FOR LM11949 BEARING	1.781
LM29710	139200	FOR LM29749 BEARING	2.563
LM501310	139400	FOR LM501349 BEARING	2.891



## Wheel Studs - Drive In

Dimensions are as follows:

A=Thread Diameter, B=Stud Length, C=Spline Length, D=Base Length, E= Spline Diameter.

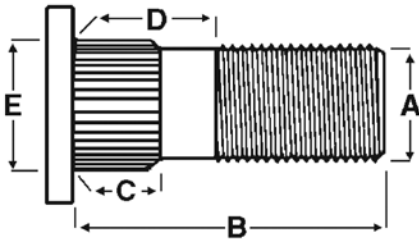

PART NO.	REF. NO.	A	B	C	D	E
LB169	144425	1/2"	1 11/16"	0.38	0.52	0.545
165981	144400	1/2"	1 1/2"	0.25	0.65	0.62
7-122**	144600	1/2"	1.99"	0.62	0.73	0.61
9251510	144750	1/2"	1 7/8"	0.26	0.52	0.54
7-246-1*	144755	1/2"	1.95"	0.26	0.61	0.54
LB2.0	144775	1/2"	2"	0.38	0.52	0.545
7-150*	144800	1/2"	2.24"	0.62	0.73	0.61
166013	144900	1/2"	2 3/8"	0.65	0.85	0.61
165995	145000	1/2"	2 1/2"	0.68	1.38	0.54
7-262	145001	1/2"	2.70"	0.68	1.38	0.54
7-262-1*	145002	1/2"	2.70"	0.68	1.38	0.54
7-223	145300	9/16"	2"	0.31	0.75	0.69
7-132	145200	9/16"	2 5/16"	0.31	0.81	0.69
7-257	145310	9/16"	2 1/2"	0.31	0.81	0.689
7-224	145350	5/8"	2 1/2"	0.31	1.15	0.69
7-232	145400	5/8"	2 3/4"	0.31	1.03	0.69
1660151	146000	5/8"	2 3/4"	0.79	0.97	0.65
090737	145800	5/8"	3"	0.58	0.80	0.68
7-115	145600	5/8"	3 1/8"	0.31	1.39	0.69
9251513	146400	5/8"	3 1/4"	0.58	1.45	0.66
7-194	145325	M22 X 1.5"	3 15/16"	0.50	0.72	0.97

\* Zinc Plated

\*\* Formerly 1-13/16" long

## Wheel Studs - Screw In

Screw-in studs are threaded on both ends. Dimensions are as follows:

A=Thread Diameter, B= Overall Length, C=Lug Nut End Length, D= Hub End Length.

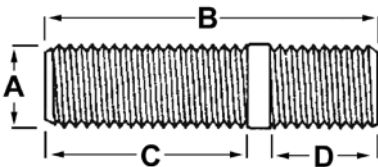

PART NO.	REF. NO.	A	B	C	D
25-53	147800	1/2"	2"	1 1/16" FINE	1 3/16" FINE
25-51	148000	1/2"	2"	7/8" FINE	5/8" COARSE
25-11	148200	9/16"	3"	1 9/16" FINE	3/4" COARSE
25-48	148800	5/8"	3"	1 9/16" FINE	1" COARSE
25-13-1	149000	3/4"	2 1/2" RH	1" FINE	1 1/4" COARSE
25-13-2	149200	3/4"	2 1/2" LH	1" FINE	1 1/4" COARSE

## Wheel Bolts

Use the following table to choose the correct wheel bolt. Dimensions are as follows:

A=Thread Diameter, B=Thread Length, C= Head Size.

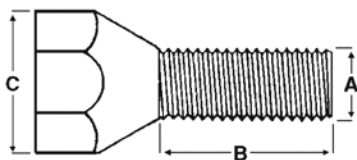

PART NO.	REF. NO.	A	B	C	DESCRIPTION
X1064	143200	1/2"	7/8"	1 3/16"	FINE THREAD, 60° CONED
LB509	143300	1/2"	7/8"	1 3/16"	FINE THREAD, 90° CONED
LB569	143400	9/16"	1 1/8"	7/8"	FINE THREAD, 90° CONED
090753	143600	1/2"	1 5/8"	7/8"	COARSE THREAD, FLAT HEAD
090702	143800	1/2"	1 7/8"	7/8"	FINE THREAD, FLAT HEAD
7-23	144000	1/2"	2 1/4"	7/8"	COARSE THREAD, FLAT HEAD

## Packaged Wheel Bolts & Studs

PART NO.	REF. NO.	DESCRIPTION
RG02-020	142900	WHEEL BOLT, 1/2" DIA., 13/16" HEAD, 1" LONG, 60° (QTY 4)
RG02-040	142910	WHEEL BOLT, 1/2" DIA., 13/16" HEAD, 7/8" LONG, 90° (QTY 4)
RG02-060	142920	WHEEL BOLT, 9/16" DIA., 7/8" HEAD, 1 1/8" LONG, 90° (QTY 4)
RG03-020	144100	DRIVE-IN STUD, 1/2" DIA., 1 1/2" LONG (QTY 4)
RG03-040	144110	DRIVE-IN STUD, 1/2" DIA., 1 13/16" LONG (QTY 4)
RG03-060	144120	DRIVE-IN STUD, 1/2" DIA., 1 7/8" LONG (QTY 4)
RG03-080	144130	DRIVE-IN STUD, 1/2" DIA., 2 1/2" LONG (QTY 4)
RG03-120	144140	DRIVE-IN STUD, 5/8" DIA., 3 1/8" LONG (QTY 4)
RG03-140	144150	DRIVE-IN STUD, 5/8" DIA., 2 13/16" LONG (QTY 4)



AXLE  
COMPONENTS

## Wheel Nuts



PART NO.	REF. NO.	DESCRIPTION	O.D.
916N	078400	9/16" HEX NUT RH, USE W/15-2 CLAMP	7/8"
STN569	140200	9/16" HEX WHEEL RH, 90° CONED	1"
N10R	140500	7/16" WHEEL NUT RH, 60° CONED	3/4"
X1023R	140600	1/2" WHEEL NUT RH, 60° CONED	13/16"
6-53	140800	9/16" WHEEL NUT RH, 60° CONED	7/8"
6-109	141000	5/8" WHEEL NUT RH, 90° CONED	1 1/16"
X1148	141200	5/8" WHEEL NUT RH, 90° CONED	15/16"
X1149	141400	5/8" WHEEL NUT LH, 90° CONED	15/16"
95188	141600	5/8" FLANGED WHEEL NUT RH	1 1/8"
6-69-1	142000	WHEEL NUT, RH INNER BUDD TYPE (STEEL/STEEL WHLS)	1 3/16"
6-69-2	142200	WHEEL NUT, LH INNER BUDD TYPE (STEEL/STEEL WHLS)	1 3/16"
6-70-1	142400	WHEEL NUT, RH OUTER BUDD TYPE (STEEL/STEEL WHLS)	1 1/2"
6-70-2	142600	WHEEL NUT, LH OUTER BUDD TYPE (STEEL/STEEL WHLS)	1 1/2"
33-52-1	142800	WHEEL RETAINING RING 9K-12K, USE W/6-109 NUTS	N/A
6-118	141700	M22 X 1.5 WHEEL NUT, SWIVEL-FLANGE	1 5/16"

## Rim Clamps

PART NO.	REF. NO.	DESCRIPTION	USE WITH:
15-2	149600	RIM CLAMP, UTG & MH STYLE	14.5" SINGLE RIMS



## Packaged Rim Clamps and Wheel Nuts



AXLE  
COMPONENTS



PART NO.	REF. NO.	DESCRIPTION
RG01-020	139900	RIM CLAMP FOR MOBILE HOME & UTILITY 14.5" RIMS, (QTY 5)
RG01-040	139910	9/16" X 7/8" HEX WHEEL NUT RH THREAD (QTY 5)
RG01-060	139920	1/2" X 13/16" CONE WHEEL NUT RH THREAD, 60° CONED (QTY 5)
RG01-080	139930	9/16" X 7/8" CONE WHEEL NUT RH THREAD, 60° CONED (QTY 4)
RG01-100	139940	5/8" X 1 1/16" CONE WHEEL NUT RH THREAD, 90° CONED (QTY 4)
RG01-120	139950	5/8" X 1 1/8" FLANGED WHEEL NUT RH THREAD (QTY 4)
RG01-150	139980	1/2" WHEEL LOCK SET, INCLUDES 2 LOCKS & 1 KEY

## Boxed Hub Assemblies



Each Kit Contains:

- Hub with pressed in Race & Studs
- Bearings
- Grease Cap
- Grease Seal

84545BX

PART NO.	REF. NO.	BOLT PATTERN	OUTER BEARING	INNER BEARING	SEAL	FITS SPINDLE
34822BX	105410	4 ON 4"	L44643	L44643	34823	BT8
34822545BX	106210	5 ON 4.5"	L44643	L44643	34823	BT8
84545BX	107010	5 ON 4.5"	L44649	L68149	58846	#84
84550BX	107810	5 ON 5"	L44649	L68149	58846	#84